

# MADISON HANSEN

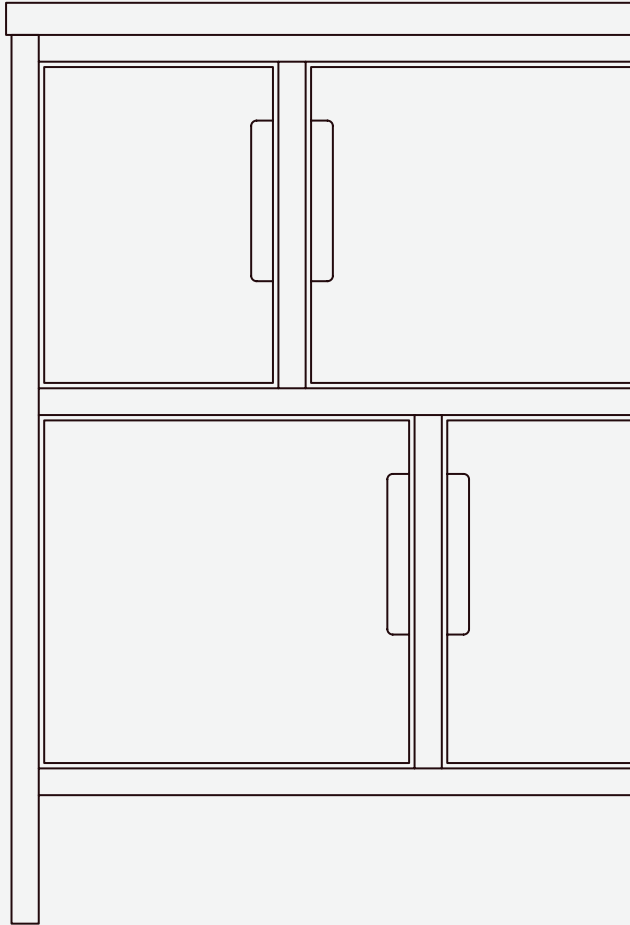

Industrial Designer - Design Engineer - Furniture Maker

# ABOUT ME



BFA Industrial Design  
University of Illinois  
Urbana-Champaign

Grand Rapids, MI  
815-272-7214  
madison.a.hansen@gmail.com  
madisonahansen.com

Hi, I'm Madison, but you can call me Maddie. I have worked in the Furniture industry for 6 + years and have truly found my passion. I started out as a fabricator, and learned from some of the best benchman in the industry. I excelled and perfected use of tools, finishing, and acute sense of tolerance.

I have always had a passion for beautiful and sustainable objects, which led me to furniture. Furniture design runs in my family, stemming from my Grandpa who studied Industrial Design and worked for Brody Seating. I am always learning from him and we still have discuss new and old projects to this day.

My aesthetic exists in the middle ground between sculpture and functionality. I take great pride in creating thoughtfully built pieces that will last a lifetime.

# INSPIRATION



Warren Platner



Andrea Zittel

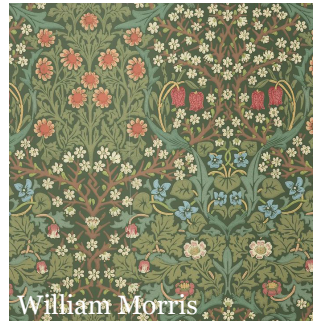

William Morris

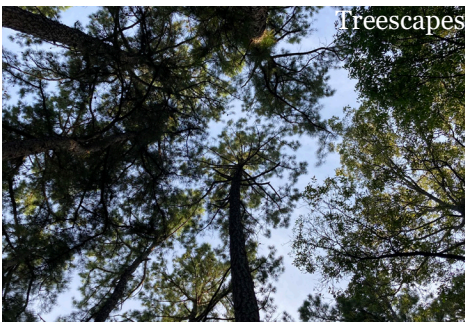

Treescapes



Aleksandra Zee



Grandpa's Cabin



Nelson Saucer  
Bubble Pendant

# CONTENTS

## Zakrose

Salt Shed  
Old Post Office Lighting  
Reisner Forgan Dining Table

## Toolbox

Hand Sketching  
Sketchbook Sketching

## My Work

Dresser  
Dining Table  
Various Work  
Media Console

## References

Zak Rose  
Andrew Kephart  
Dan Sullivan



Zak Rose designs in an approachable style, creating pieces with light forms, clean lines, beautiful materials, and functional considerations.

## Major Bar Cart / Role: Design Engineer through various versions





Roman & Williams Guild Slab Bed / Role: Fabricator



# SALT SHED, CHICAGO

Role: Created engineered shop drawing based off of Blue Star architectural drawings and site measurements. Saw project through various versions. Created installation drawings and oversaw union install.

## Materials:

- Stainless Steel Counter with Patina
- Stainless Steel Back Bar
- Gloss Laminate Front Panels
- Solid Walnut Rear Shelf

## Bar 1

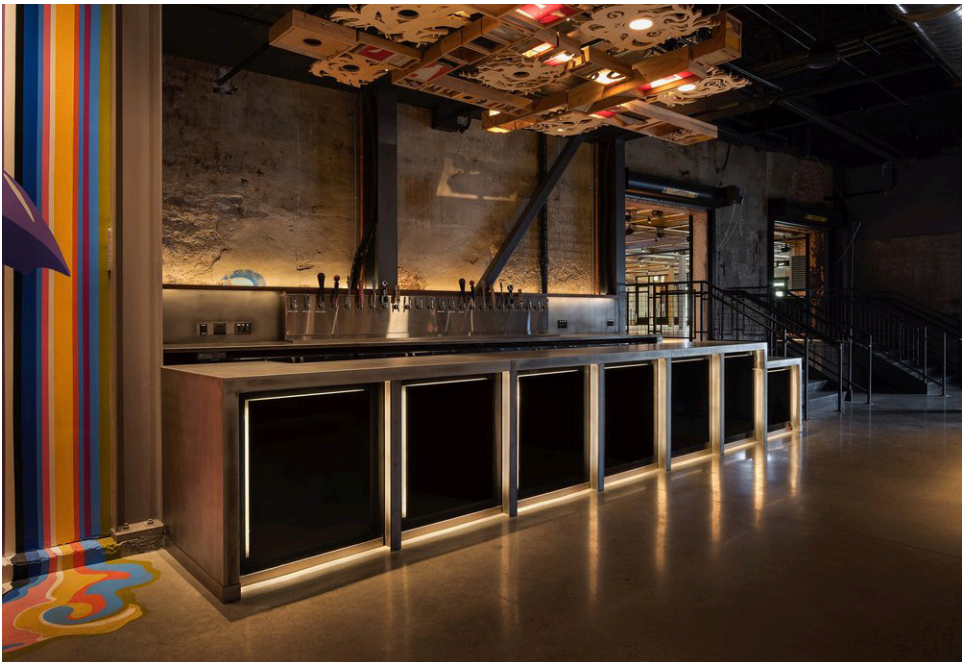

Materials:

- Inner Steel Frame
- Walnut Veneer MDF “Cabinets”
- Solid Walnut Moulding

## VIP Back Bar



# OLD POST OFFICE, CHICAGO

From Here On / Pendant

Materials:

- Spun Aluminum Shade, Reflector
- Omnilite LED lights

Role: Saw initial design concept through multiple versions. Fully engineered final concept



# From Here On / Barrel Hanging Fixture

Materials:

- Powder Coated Steel Frame, Straps
- 1/2in Pyrex Tube
- 1/16in LDPE diffuser
- Onmilite LED Lights

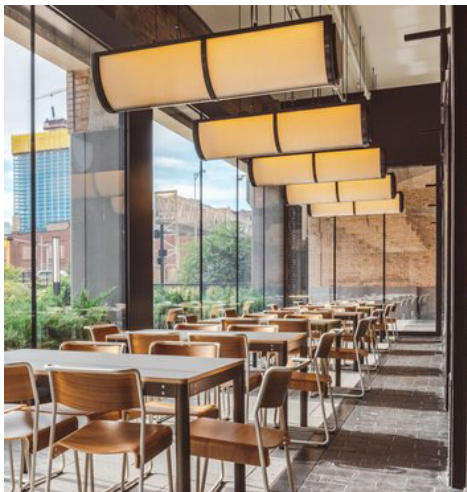

# REISNER-FORGAN

## DINING TABLE

### Materials:

- Brass Feet - Laser Cut
- Brass Tube
- Aluminum Slides - Custom ordered through Poetker US
- Solid Oak Bull-nose Moulding - Custom
- Econokore Top with custom veneer
- Veneer Wrapped poplar base

Role: Design engineer through multiple versions. Took initial designer drawings to fully engineered table. Worked with Poetker to order custom aluminum slides. Decided on materials and fabrication order of operations. Helped with fabrication and delivery.

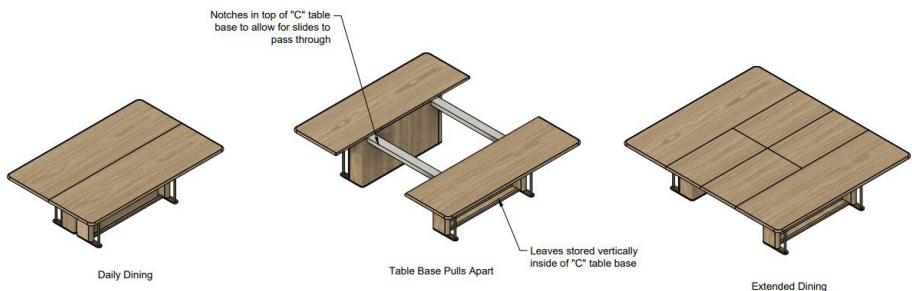



# REISNER-FORGAN DINING TABLE

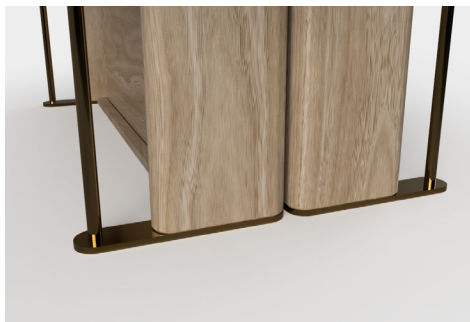
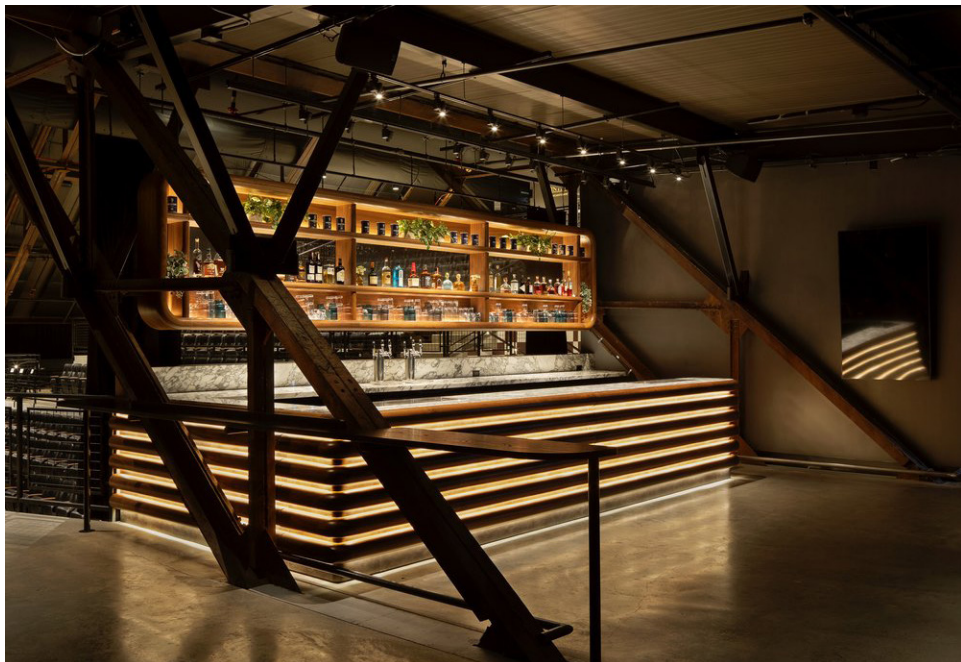



# SKETCHING & IDEATION

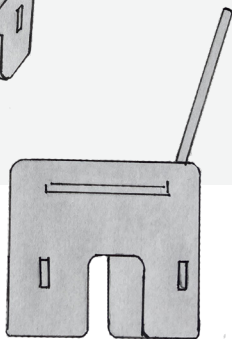
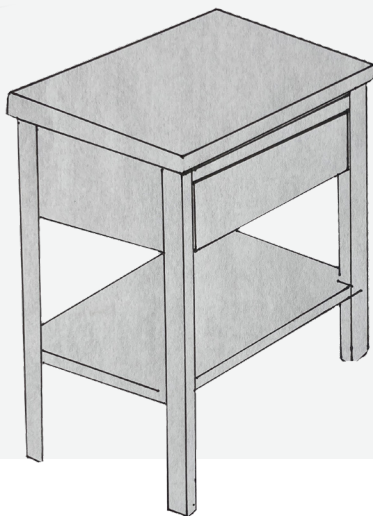
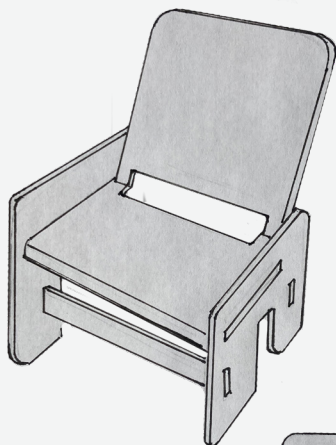
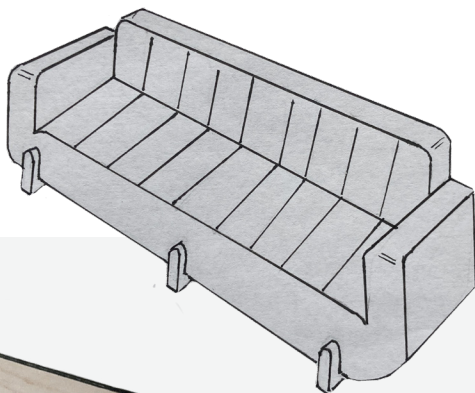

## Hand-Drawn Concept Sketches

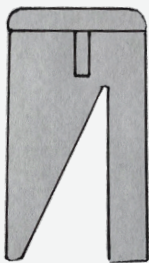
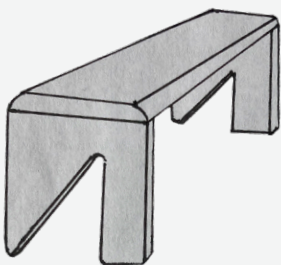
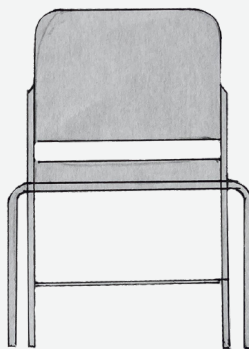
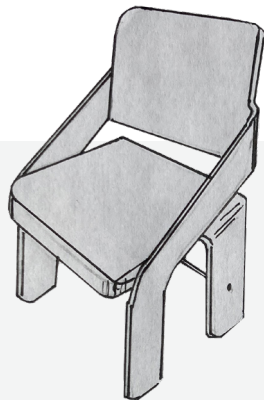
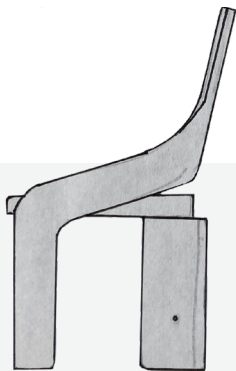

# STARTEX INC. CONCEPTS

Lighting & Chair sketches using Sketchbook

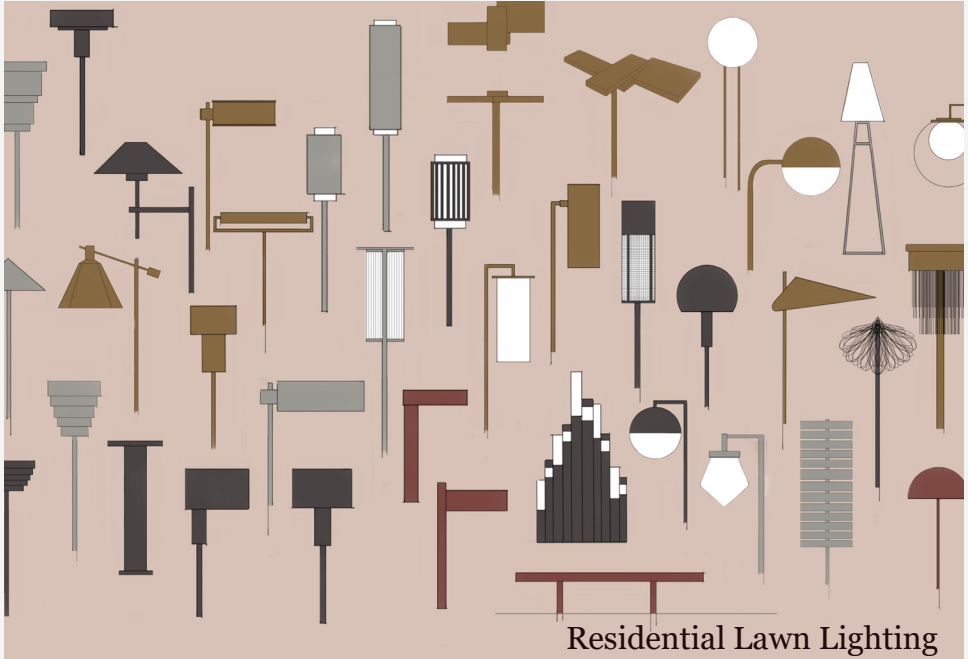

Residential Lawn Lighting



Hospitality Pendant Lighting



Hospitality Task Seating

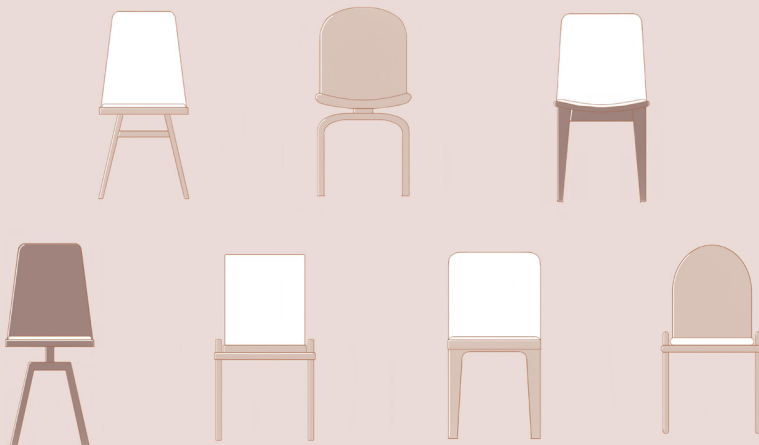

Hospitality Task Seating

# PERSONAL WORK

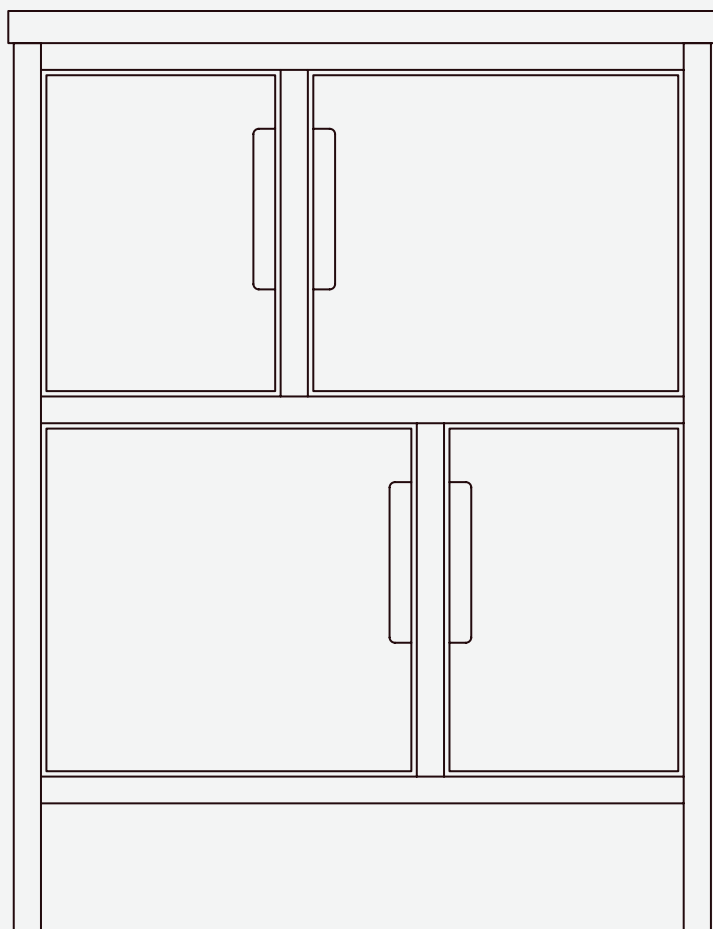

Materials:

- Oak Veneer Particle Board
- Solid Oak Edging, Base
- Powder Coated steel backers

# DRESSER

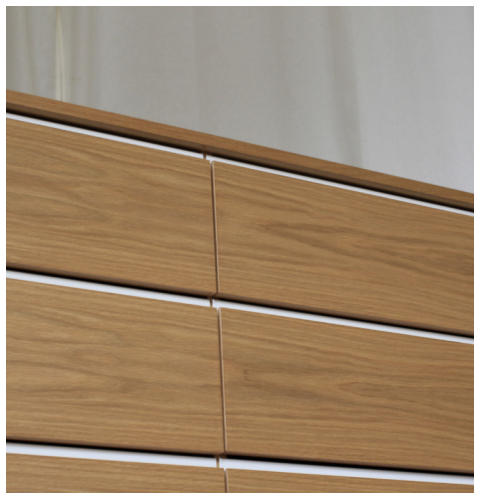

# DINING TABLE

Materials:

- Solid Ash
- Powder Coated Legs
- Powder Coated Straighteners Below
- Powder Coated Machine Screws





# VARIOUS WORKS





# VARIOUS WORKS



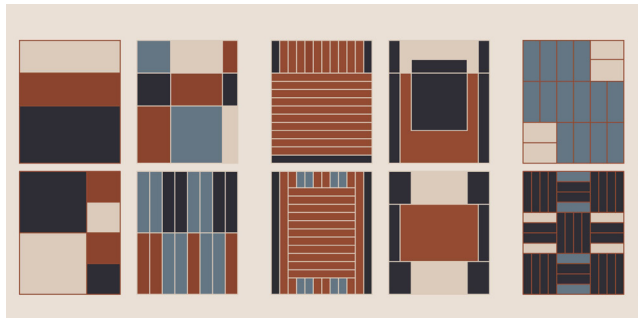

# MEDIA CONSOLE

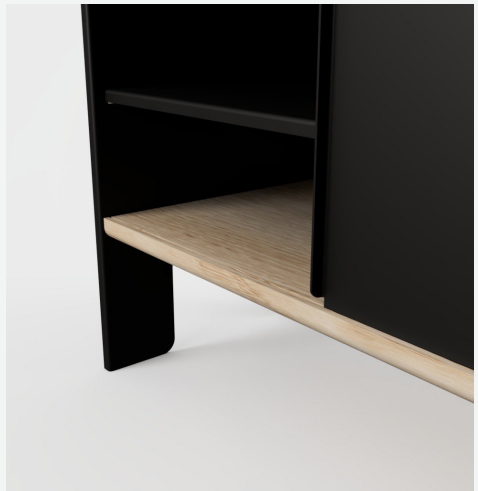



### Materials:

- Solid Red Oak
- Laser Cut & Bent Legs, Door, Shelf, Dividers / Painted
- Oak on MDF Back

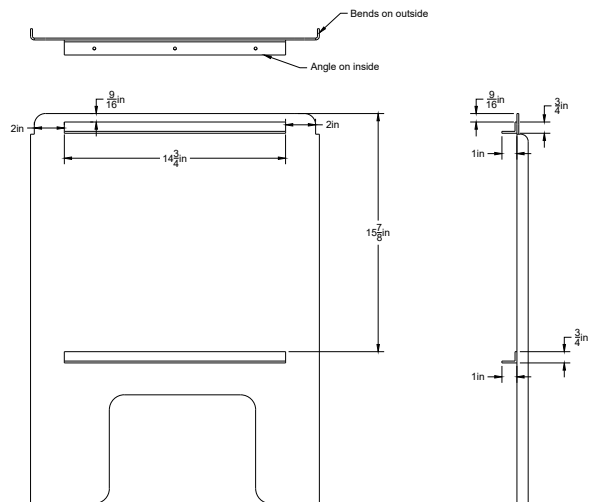

# MEDIA CONSOLE

**V1**

- Solid Oak Cabinet
- Solid Oak Legs
- Steel Sliding Door



**V2**

- Solid Oak Cabinet
- Top Dominant
- Steel Sliding Door
- 1/4in Laser Cut Steel Legs



# V3

- Solid Mitered Oak Cabinet
- Steel Sliding Door
- 1/4in Laser Cut Steel Legs



# V4

- Rounded front edge
- Laser cut & bent steel legs
- Steel sliding door
- Steel Shelf, Dividers
- KD





“We design & manufacture custom solutions for any  
built environmet”

# Fixture Renders

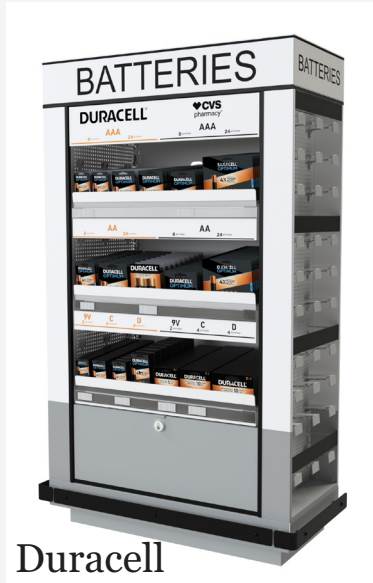

**BDB Low Gondola S25**  
Install Instructions



Isometric View

COMPONENT KIT SPOTTERS GUIDE:  
FINAL ASSEMBLY OF COMPONENTS

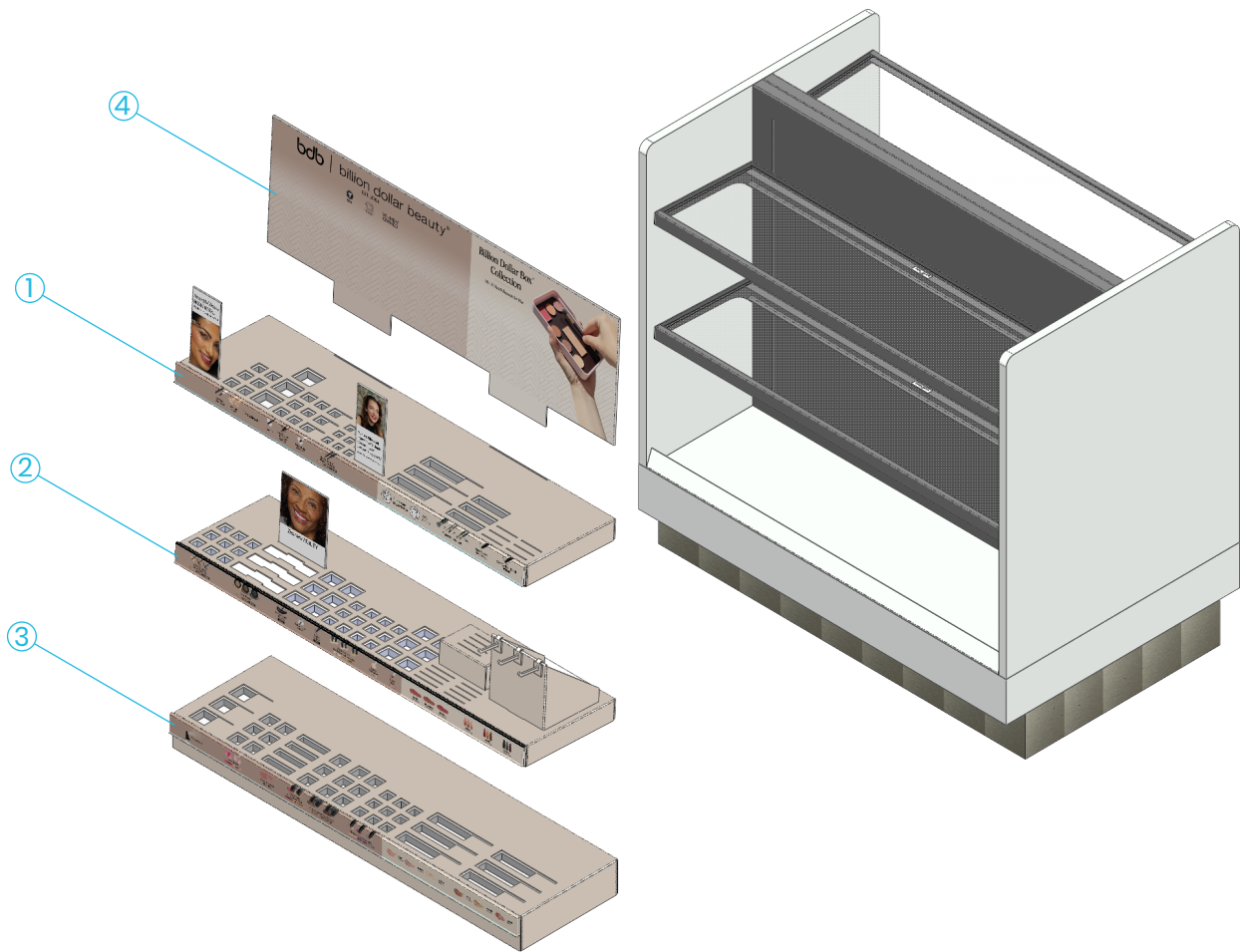

Exploded Isometric View

ITEM	PART NUMBER	QTY	DESCRIPTION
1	SUB56776	1	BDB TOP SHELF
2	SUB56783	1	BDB MIDDLE SHELF
3	SUB56784	1	BDB BOTTOM SHELF
4	GRA51604	1	HEADER GRAPHIC

**COMPONENT KIT SPOTTERS GUIDE:**  
INDIVIDUAL COMPONENTS

**BDB TOP SHELF COMPONENTS**

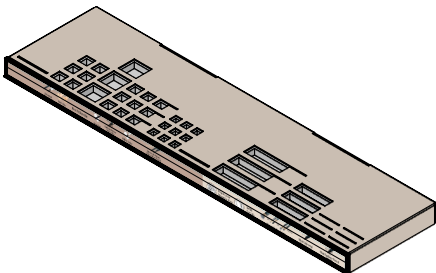

**BDB TOP SHELF**  
(QTY 1)

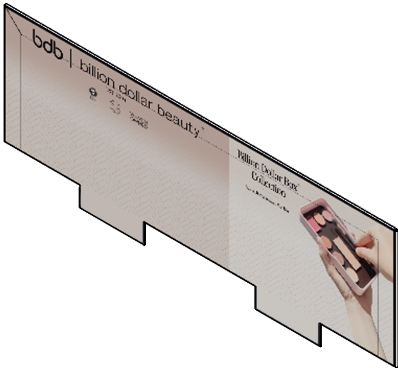

**HEADER GRAPHIC**  
(QTY 1)



**GRAPHIC A (**  
**QTY 1)**



**GRAPHIC C**  
(QTY 1)

**BDB MIDDLE SHELF COMPONENTS**

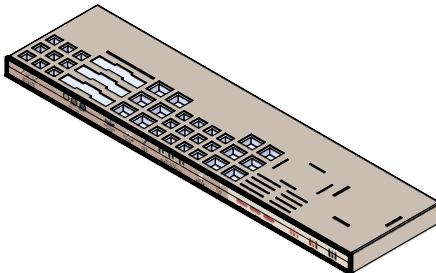

**BDB MIDDLE SHELF**  
(QTY 1)



**GRAPHIC B**  
(QTY 1)

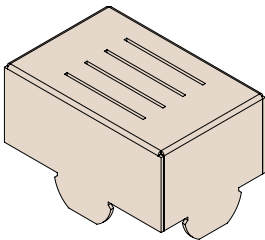

**LIP BALM RISER**  
(QTY 1)

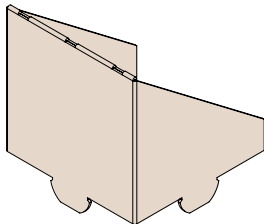

**PEG HOOK RISER**  
(QTY 1)

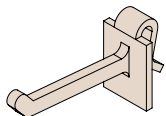

**PEG HOOK**  
(QTY 3)

**BDB BOTTOM SHELF COMPONENTS**

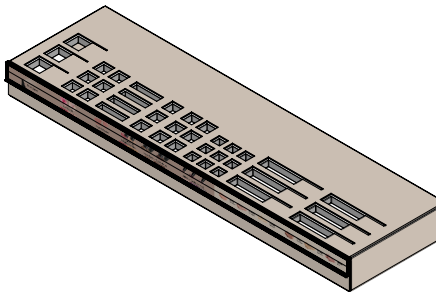

**BDB BOTTOM SHELF**  
(QTY 1)

# BDB Low Gondola S25

## Install Instructions

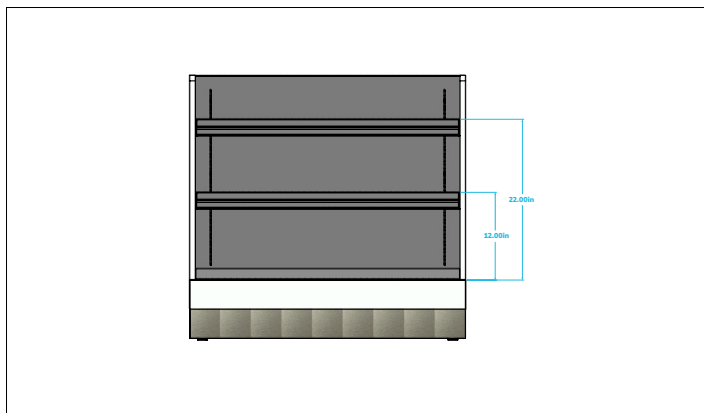

### Step 1:

Make sure shelves are set at above heights measuring from the inside of the unit to the top of each shelf; 12in & 22in.

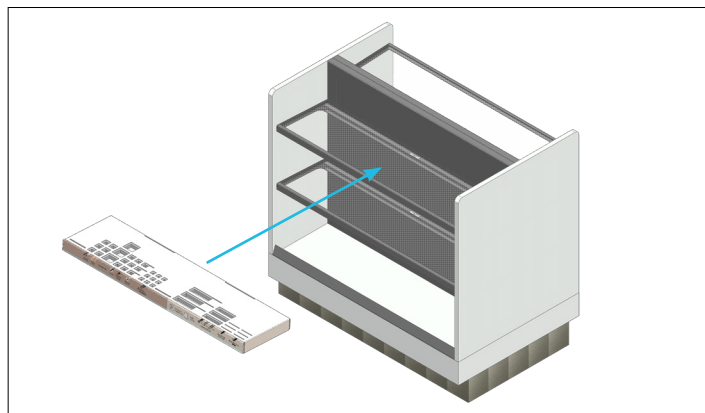

### Step 2:

Insert **BDB Top Shelf** onto gondola top shelf.

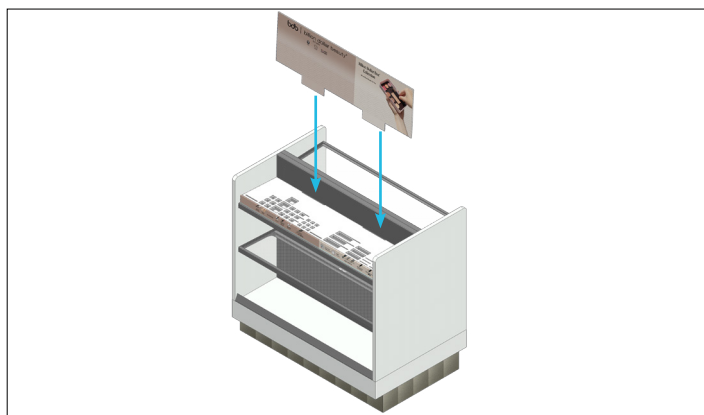

### Step 3:

Insert **Header Graphic** into rear slots on **BDB Top Shelf**.

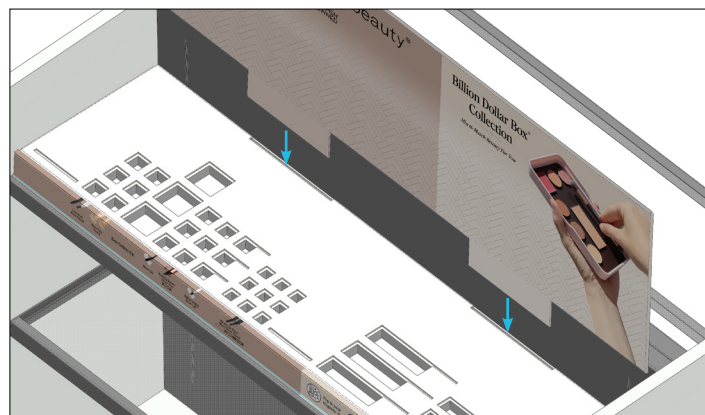

### Detail 3:

See slots at rear.

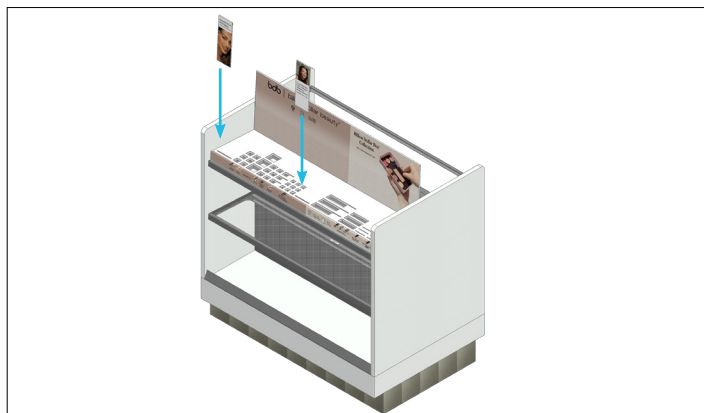

### Step 4:

Insert **Graphic A** & **Graphic C** into front slots on **BDB Top Shelf**.

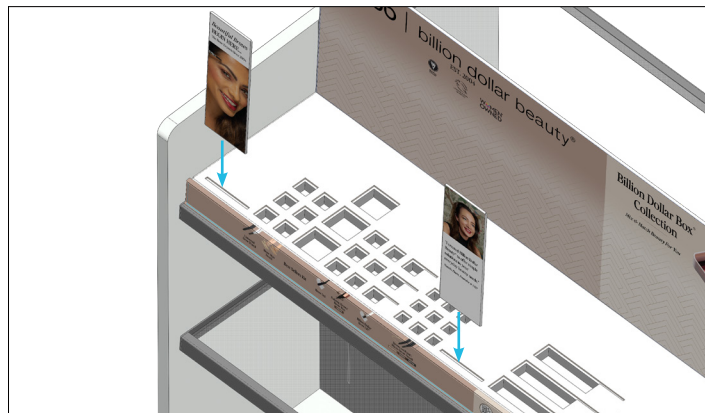

### Detail 4:

See slots at front.

# BDB Low Gondola S25

## Install Instructions

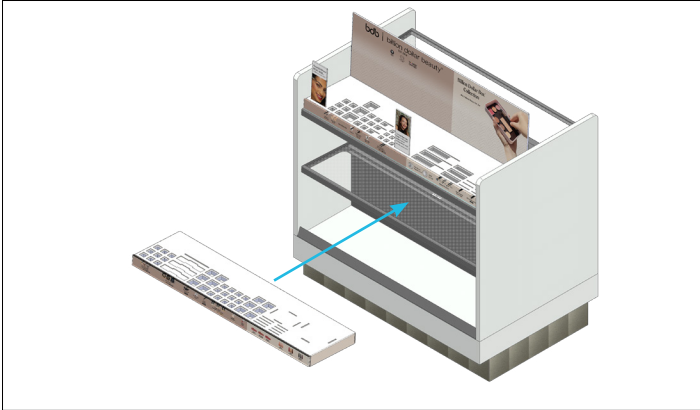

**Step 5:**  
Insert **BDB Middle Shelf** onto gondola middle shelf.

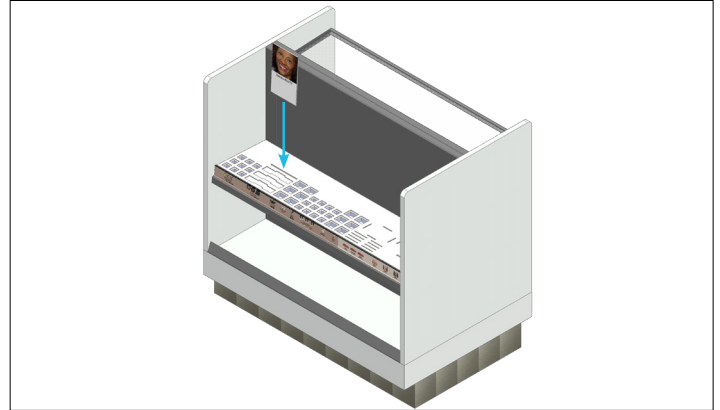

**Step 6:**  
Insert **Graphic B** into slots on **BDB Middle Shelf**.  
(Top shelf hidden for better visibility)

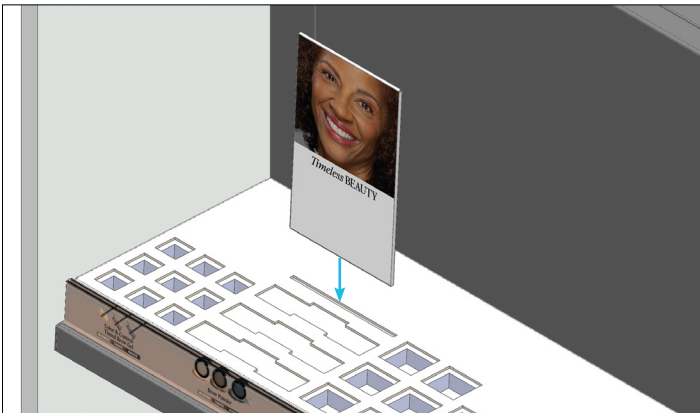

**Detail 6:**  
See slot on left side for **Graphic B**.  
(Top shelf hidden for better visibility)

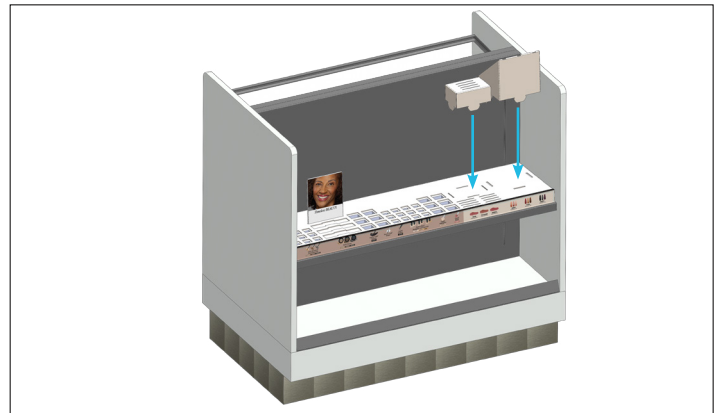

**Step 7:**  
Insert **Lip Balm Riser** & **Peg Hook Riser** onto **BDB Middle Shelf**.  
(Top shelf hidden for better visibility)

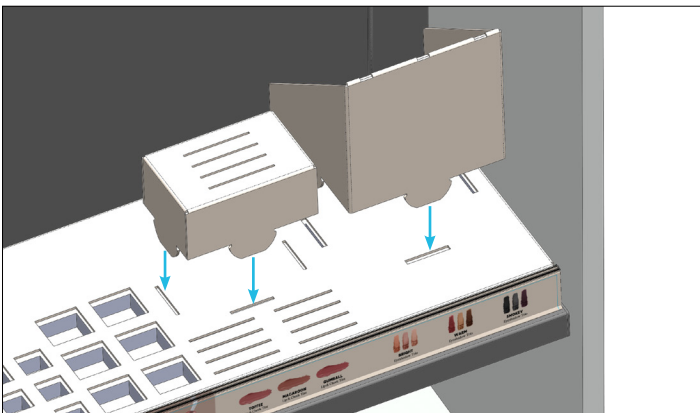

**Detail 7:**  
See slots on right side for risers.  
(Top shelf hidden for better visibility)

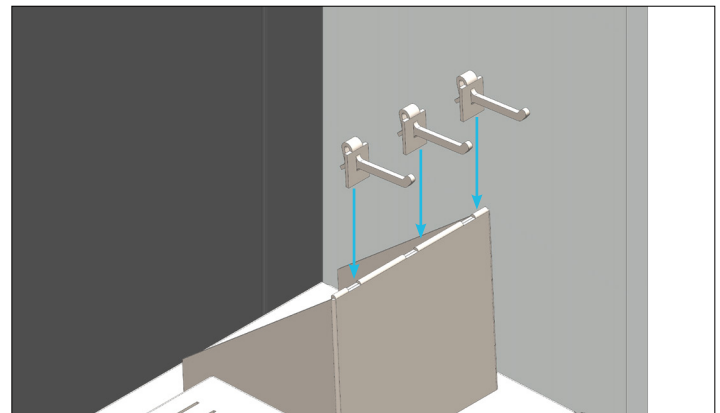

**Step 8:**  
Add **Plastic Peg Hooks** (x3) onto **Peg Hook Riser** within notches.  
(Top shelf hidden for better visibility)

## Install Instructions

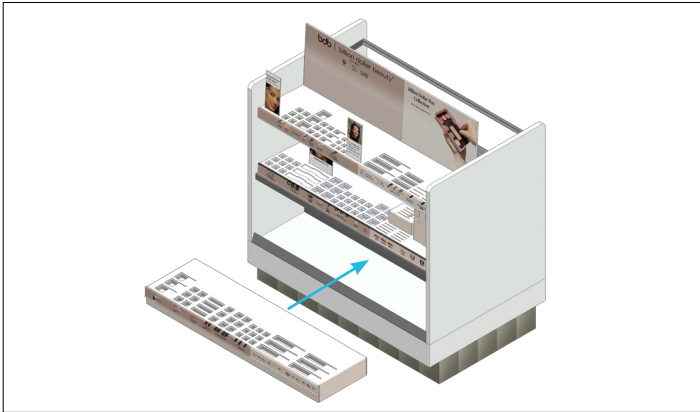

**Step 9:**  
Insert **BDB Bottom Shelf** onto gondola top shelf.

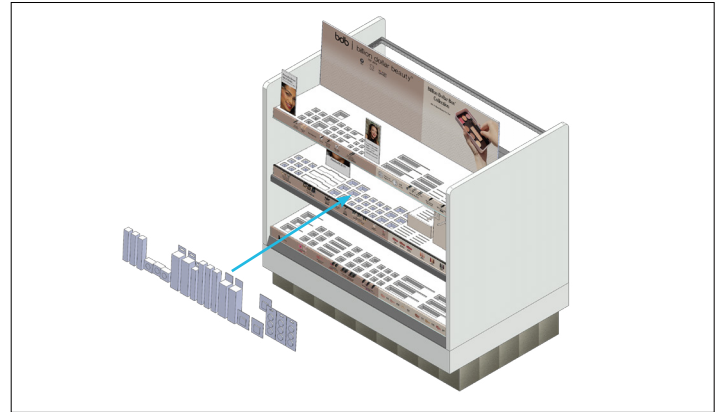

**Step 10:**  
Add products according to planogram below.

## Planogram Render

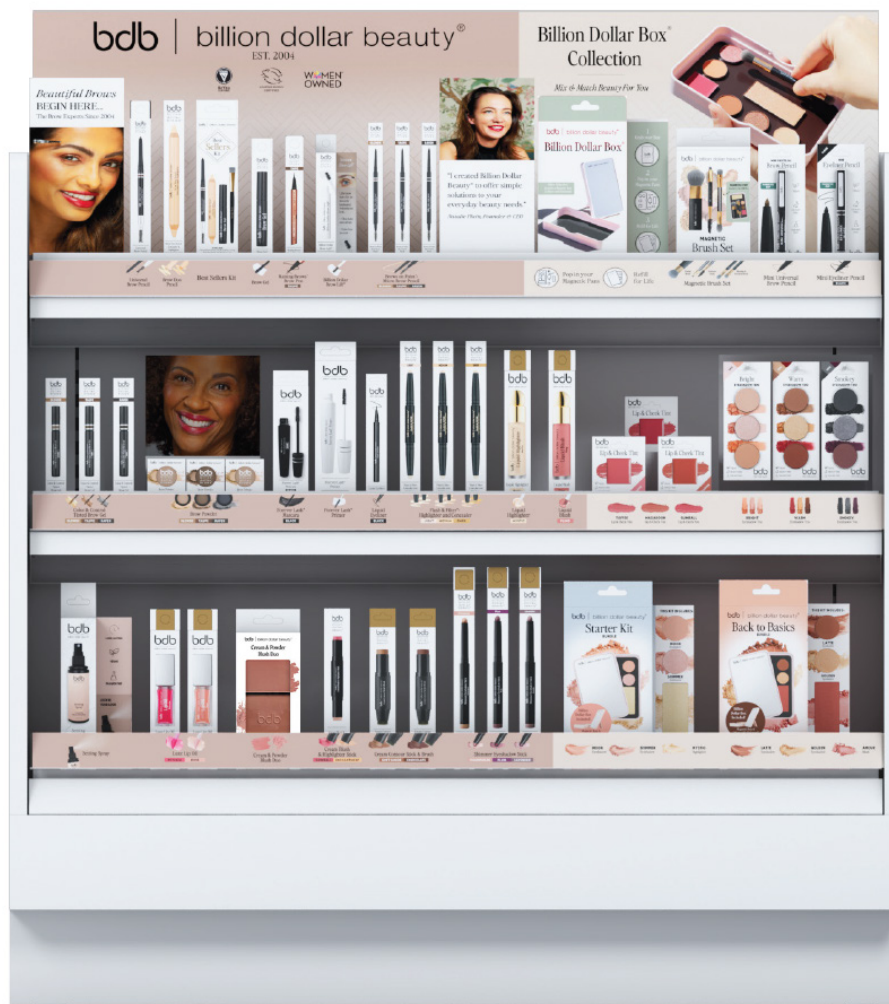

### Product Planogram Table

Position	UPC	WIC	Description
<b>3ft. BDE Assortment</b>			
<b>Shelf 1</b>			
1	793573552983	642887	Universal Brow Pencil
2	793573553065	642804	Brow Duo Pencil
3	793573311238	642866	Best Sellers Kit
4	793573552990	642858	BDB Brow Gel
5	735816871291	642916	Raising Brows
6	857630005758	NEW	BDB Brow Lift
7	793573311405	642956	Micro Brow Pencil Blonde
8	793573311429	642955	Micro Brow Pencil Taupe
9	793573311436	642958	Micro Brow Pencil Raven
10	857630005093	642418	Billion Dollar Box
11	735816878924	642415	Magnetic Brush Set
12	793611695375	642965	Eyeliner Black
13	793611695399	642954	Mini Universal Brow Pencil
<b>Shelf 2</b>			
1	793611694217	642900	Tinted Brow Gel Blonde
2	793611694224	642953	Tinted Brow Gel Taupe
3	793611695115	642915	Tinted Brow Gel Raven
4	793573553027	642841	Brow Powder Blonde
5	793573553041	642964	Brow Powder Taupe
6	793573553058	642983	Brow Powder Raven
7	793611695146	642580	Forever Lash Mascara
8	850060737077	718766	BDB Forever Lash® Primer
9	735816662998	642419	Liquid Eyeliner
10	793597818171	642990	Flash & Filter Light
11	793597818201	642930	Flash & Filter Medium
12	793597818218	642890	Flash & Filter Dark
13	850060737152	NEW	BDB Liquid Highlighter -- Mystic
14	850060737145	718777	BDB Liquid Blush -- Fling
15	857630005314	642933	Lip Balm Toffee
16	857630005307	642878	Lip Balm Macaroon
17	857630005338	642886	Lip Balm Gumball
18	735816872953	642880	Bright Eyeshadow Trio
19	735816673307	642949	Warm Eyeshadow Trio
20	735816655204	642874	Smokey Eyeshadow Trio
<b>Shelf 3</b>			
1	676525601765	NEW	BDB Setting Spray
2	850060737206	NEW	BDB Luxe Lip Oil -- Petunia
3	850060737213	NEW	BDB Luxe Lip Oil -- Rose
4	857630005802	718790	Cream and Powder Blush Duo
5	857630005604	718795	BDB Cream Blush & Highlighter Stick
6	857630005611	718806	BDB Cream Contour Stick & Brush - Soft Suede
7	850060737084	718773	BDB Cream Contour Stick & Brush - Chocolate
8	850060737169	718765	BDB Starstruck Shimmer Eyeshadow Stick -- Champagne
9	850060737176	718775	BDB Starstruck Shimmer Eyeshadow Stick -- Plum
10	850060737183	718770	BDB Starstruck Shimmer Eyeshadow Stick -- Lavender
11	735816658472	642416	Starter Kit
12	676525821576	642417	Back to Basics

See instructions below on how to access the portal to order graphics and fixtures:

1. Log on to the Beauty Differentiation Portal (<https://walgreenscoswall.hamacher.com/>)
2. Input your Store Number for both Store Number/Store Password
3. Proceed to "Planogram & Resets", then select the planogram you need to view/download

**Back Room Flute Wall Cover**  
Install Instructions

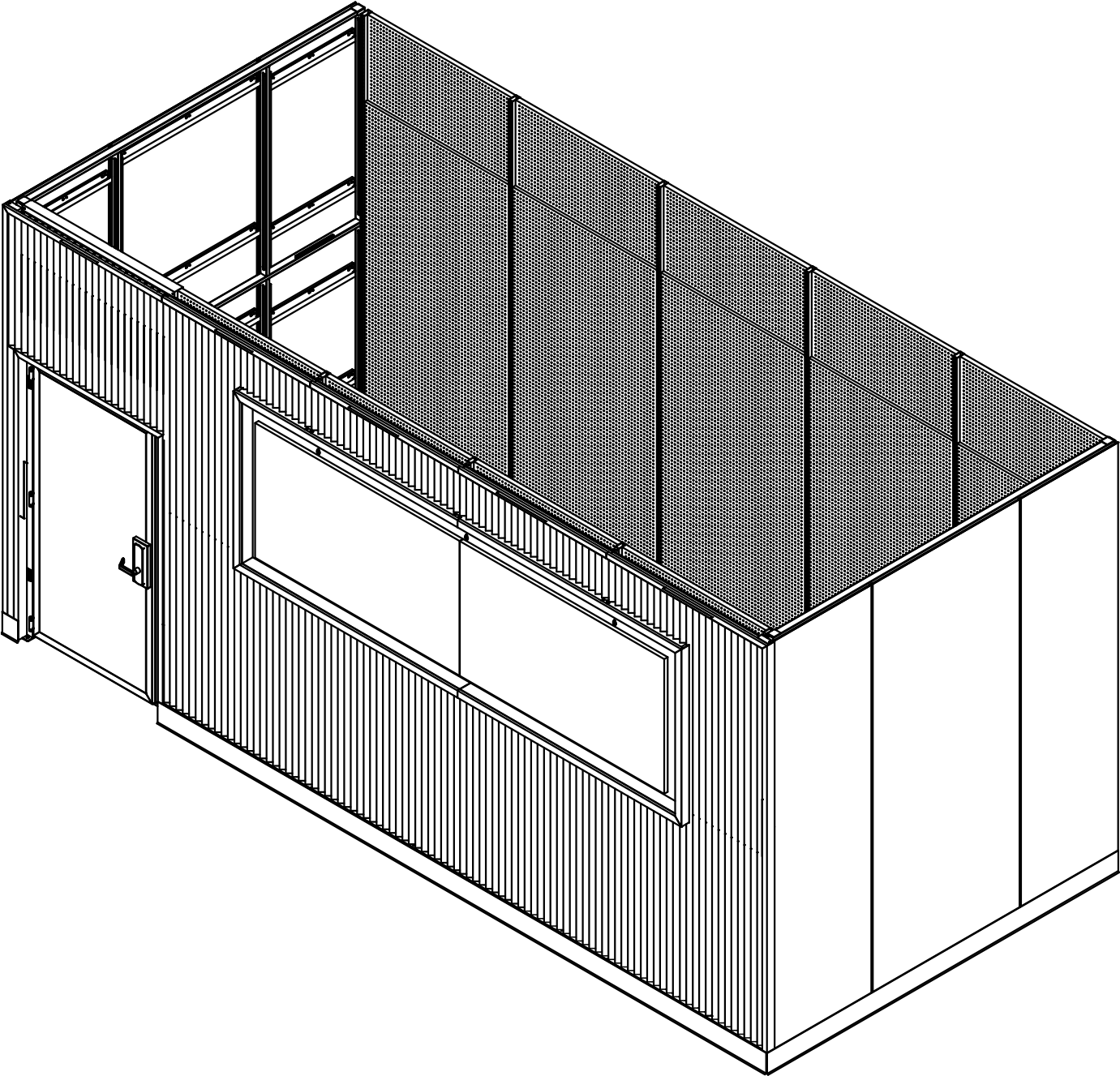

COMPONENT KIT SPOTTERS GUIDE

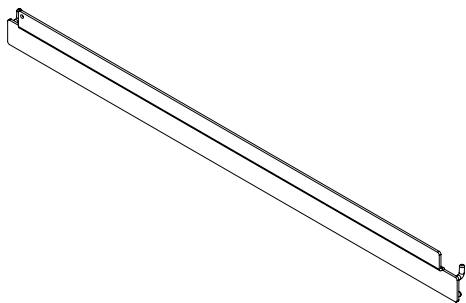

Z HANGER 31.32" (QTY 16)  
MPM528086

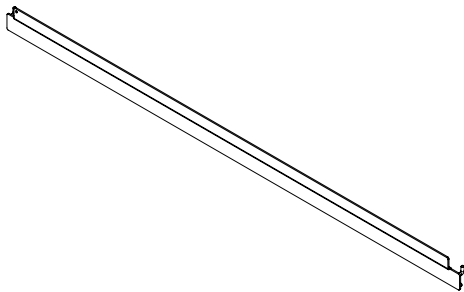

Z HANGER 48.375" (QTY 4)  
MPM528689

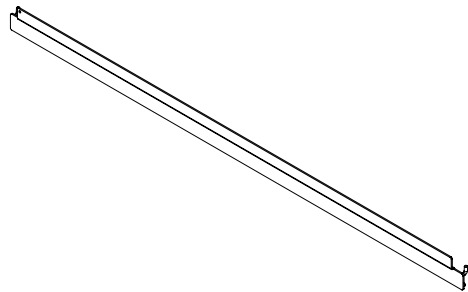

Z HANGER 48.5" (QTY 14)  
MPM528075-MPM528088

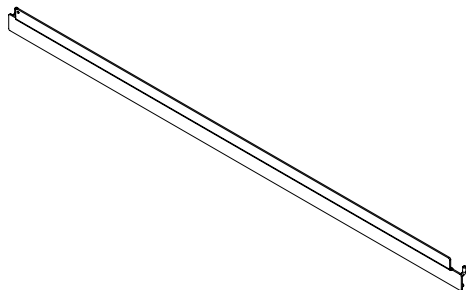

Z HANGER 48.56" (QTY 8)  
MPM531039

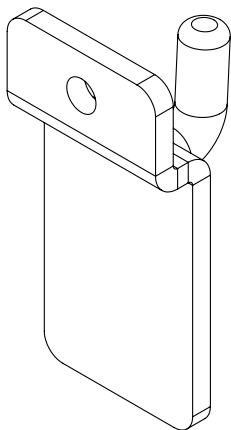

Z HANGER 1" (QTY 4)  
MPM528551

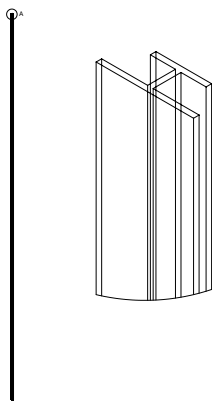

CLEAR H-CHANNEL (QTY 4)  
MPP512188



CENTER OUTSIDE PANEL (QTY 2)  
SUB56570



SMALL OUTSIDE PANEL (QTY 4)  
SUB56771

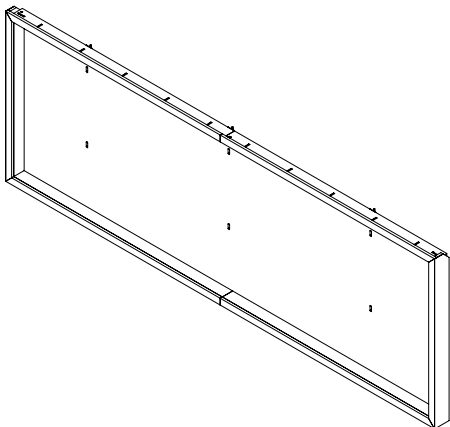

TV FRAME ASSEMBLY (QTY 1)  
SUB56770

COMPONENT KIT SPOTTERS GUIDE

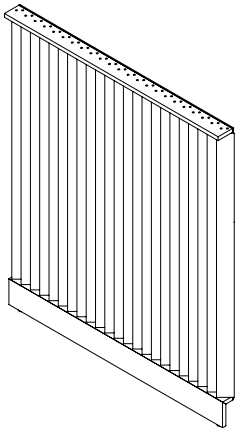

LOWER PANEL ASSEMBLY 1 (QTY 1)  
SUB56756

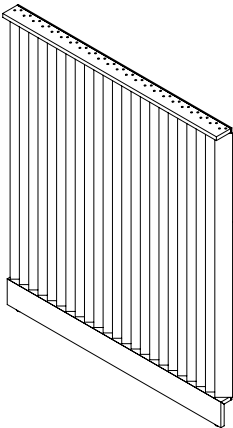

LOWER PANEL ASSEMBLY 2 (QTY 1)  
SUB556795

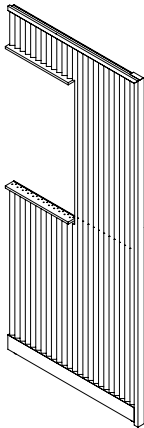

RIGHT PANEL ASSEMBLY (QTY 1)  
SUB56573

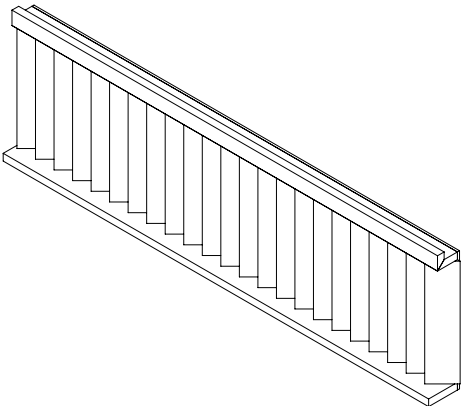

UPPER PANEL ASSEMBLY 1 (QTY 1)  
SUB56794

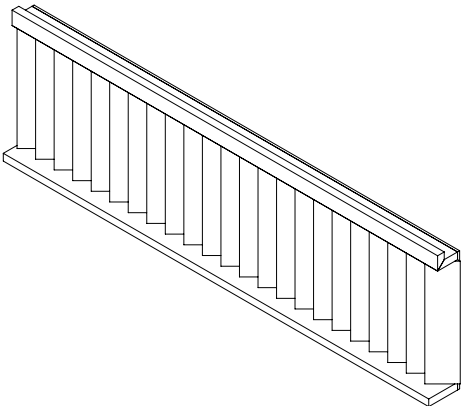

UPPER PANEL ASSEMBLY 2 (QTY 1)  
SUB56768

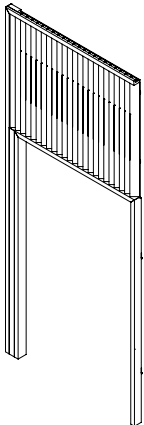

LEFT PANEL ASSEMBLY (QTY 1)  
SUB56574

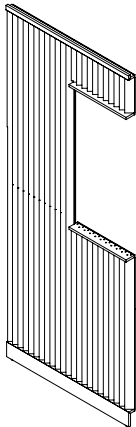

48IN LEFT PANEL ASSEMBLY (QTY 1)  
SUB56769

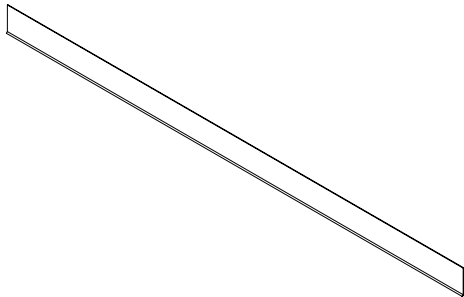

VINYL BASE BOARD 113.76" (QTY 2)  
MPP511035

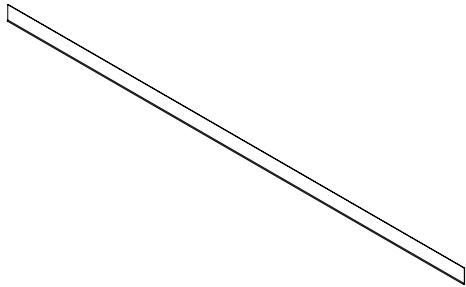

VINYL BASE BOARD 197.08" (QTY 1)  
MPP511381

COMPONENT KIT SPOTTERS GUIDE

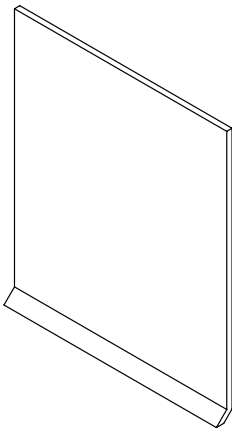

VINYL BASE BOARD 5.07" (QTY 1)  
MPP511555

HARDWARE KIT SPOTTERS GUIDE

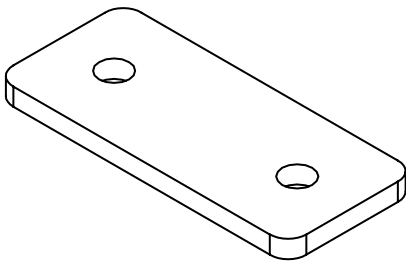

CONNECTION PLATE (QTY 6)  
MPM528752

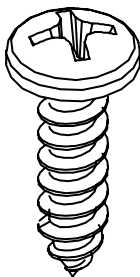

SCREW, #6 X 1/2" PHILIPS (QTY 12)  
HWD17523

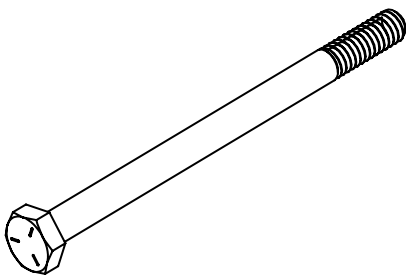

BOLT, HEX HEAD 1/4-20 X 3" (QTY 6)  
HWD52913

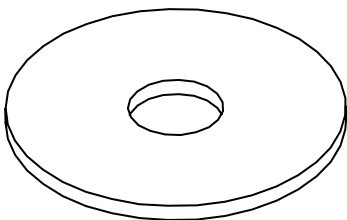

WASHER FLAT 1" O.D. (QTY 12)  
HWD14962

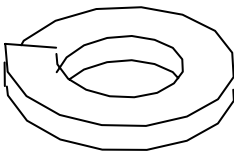

LOCK WASHER FOR 1/4" (QTY 6)  
HWD14043

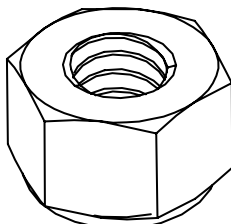

LOCK NUT 1/4-20 (QTY 6)  
HWD16754

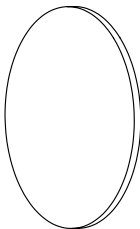

MINIFIX COVER CAP (QTY 2)  
HWD53133

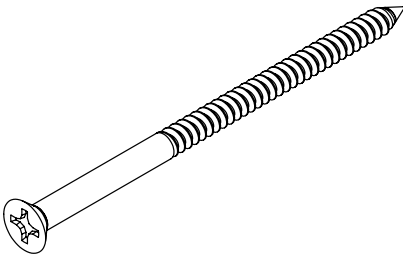

SCREW, #8 X 3" PHILIPS (QTY 2)  
HWD13718

# Back Room Flute Wall Cover

## Install Instructions

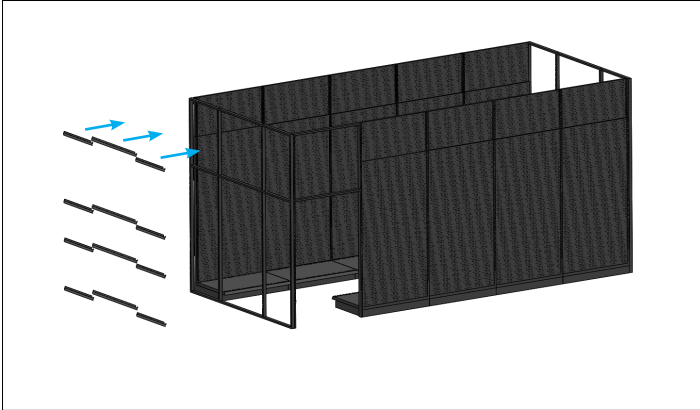

**Step 1:**  
Locate **Z Hanger 31.32in** (x8) and **Z Hanger 48.56in** (x4). Install these on left side of Madix gondola. See page 9 for heights of these brackets.

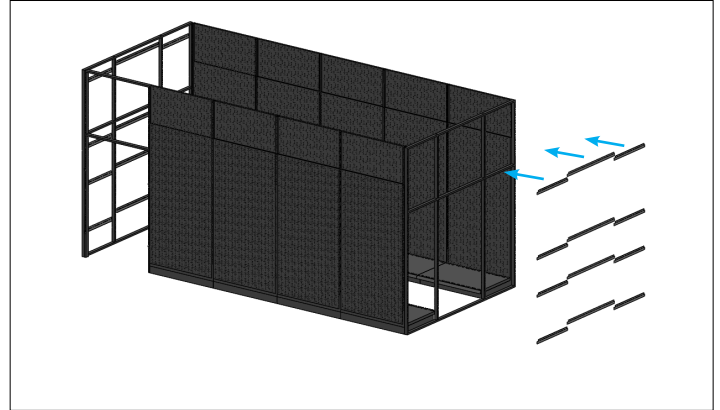

**Step 2:**  
Repeat step 1 on right side of Madix gondola. Hang z hangers at same heights as left side.

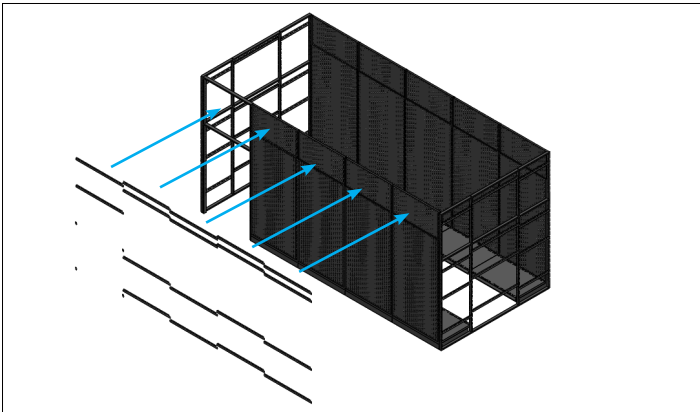

**Step 3:**  
Locate **Z Hanger 1in** (x4), **Z Hanger 48.5in** (x14), and **Z Hanger 48.375** (x4). Install these brackets on front of Madix gondola. See page 10 for detailed layout and dimensions.

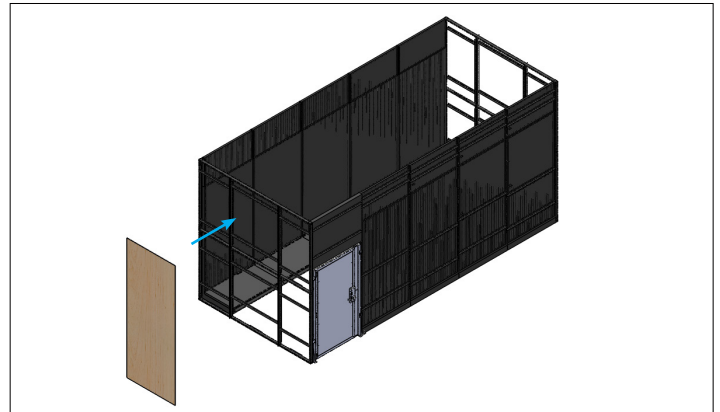

**Step 4:**  
Install **Center Outside Panel**, centered on left side of Madix gondola.

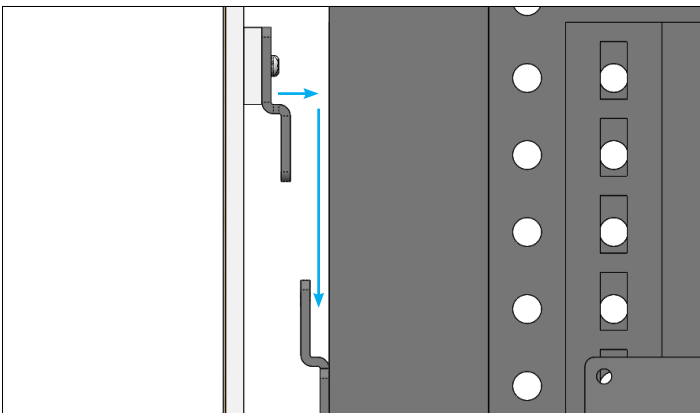

**Detail 4:**  
To install all panels, lift panel up and over, then slide down to engage with z channel.

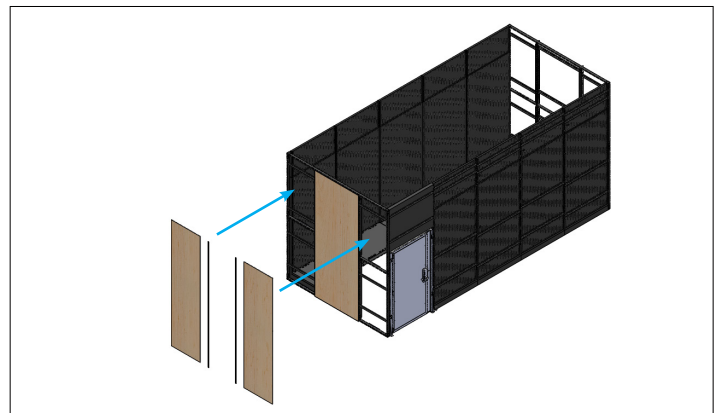

**Step 5:**  
Hang **Small Outside Panels** (x2) on either side of center panel. Using mending plates on center panel, ensure double sided tape will stick to outside panels once in place. Place **H-Channel** (x2) between panels to keep aligned.

# Back Room Flute Wall Cover

## Install Instructions

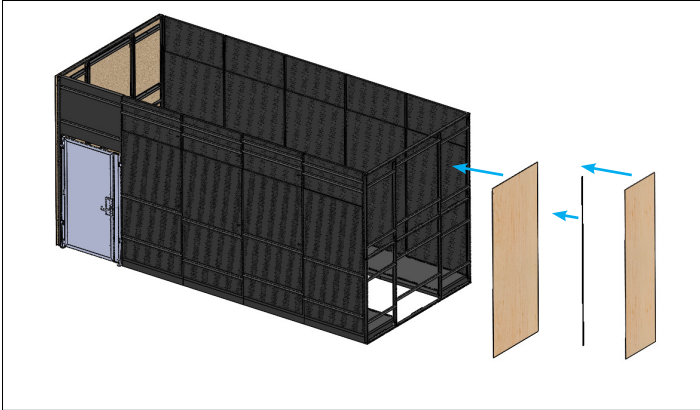

**Step 6:**  
On right side of Madix gondola, install **Center Panel** (x1) and **Outside Panel** (x1) on right side of center panel. Place **H-Channel** (x1) between to align. Leave last Outside Panel aside for now.

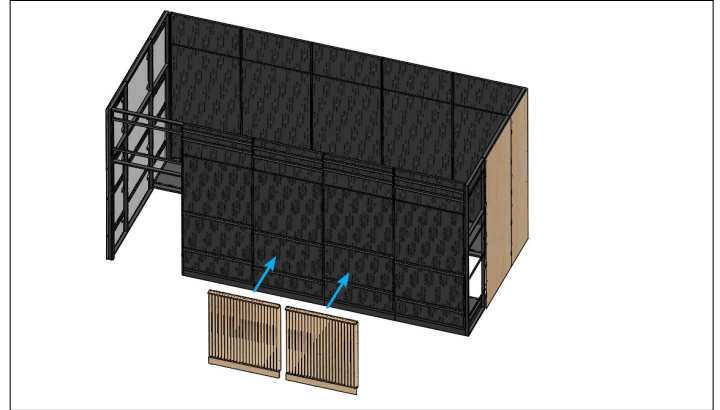

**Step 7:**  
Hang **Lower Panel Assemblies** (x2) in middle two sections of gondola front.

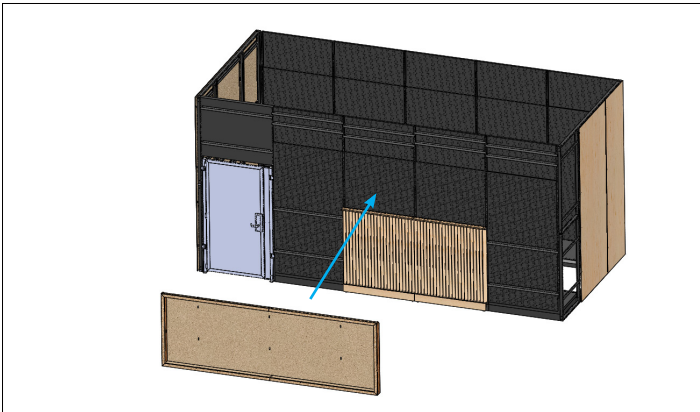

**Step 8:**  
Locate **TV Frame Assembly**. This will be installed with the top peg hook in the 15th hole from the top of the gondola. See Detail 9.

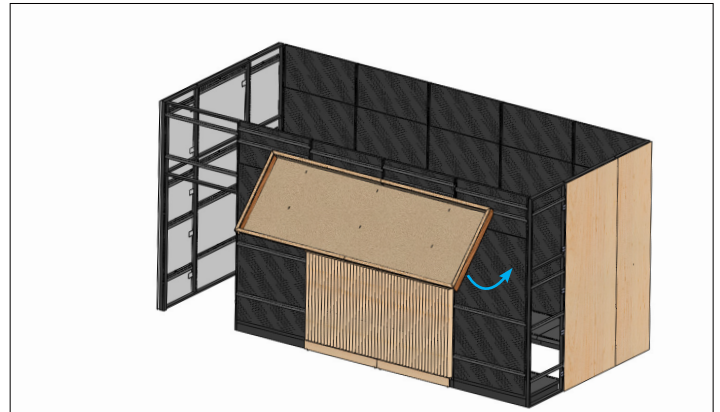

**Step 9:**  
Insert peg hook, and rotate downward to engage lower peg-hook.

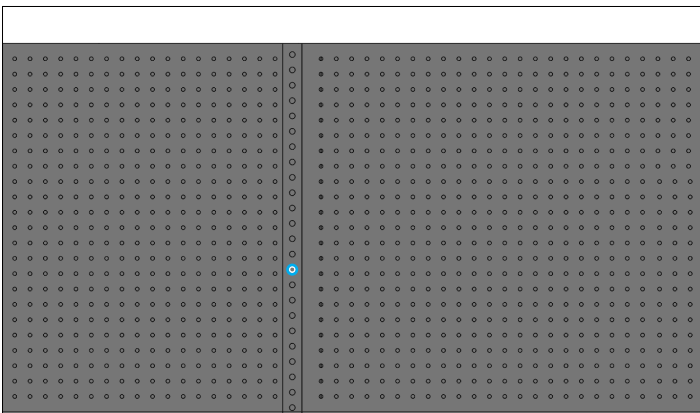

**Detail 9a:**  
See 15th hole from top of gondola.

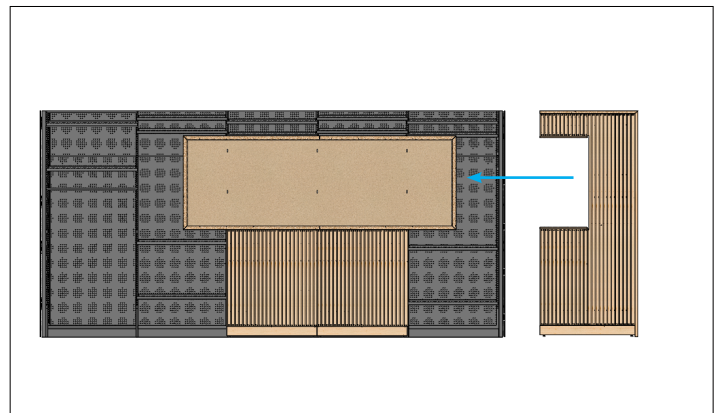

**Detail 10:**  
Now, slide **Right Panel Assembly** onto Z Hangers from right side. You will not be able to lift this into place, it must slide.

# Back Room Flute Wall Cover

## Install Instructions

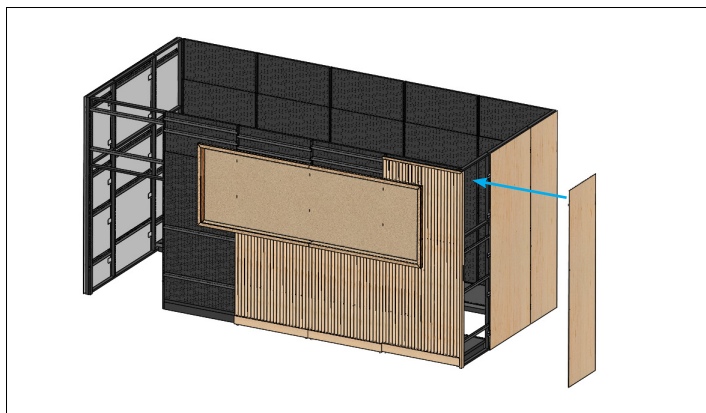

**Step 11:**  
Hang last **Outside Panel** on right side of gondola.

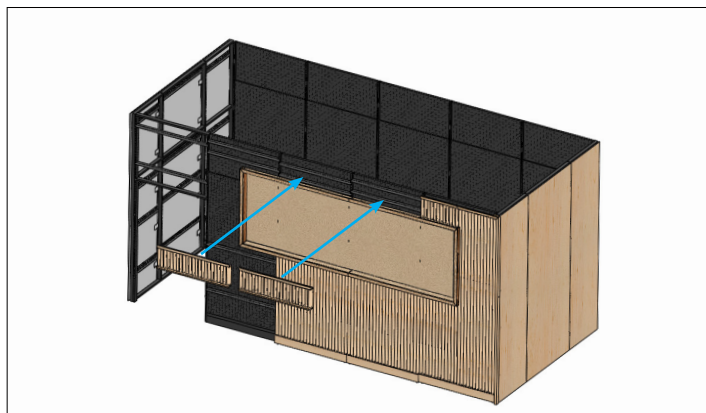

**Step 12:**  
Hang **Upper Panel Assemblies** (x2) above **TV Frame**.

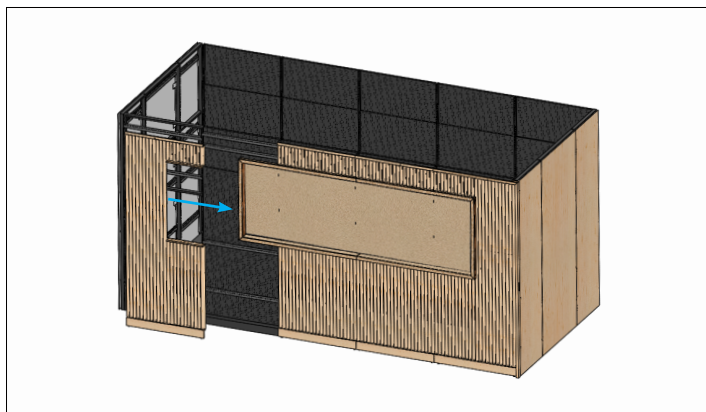

**Step 13:**  
Slide on **48in Left Panel Assembly** from left side.

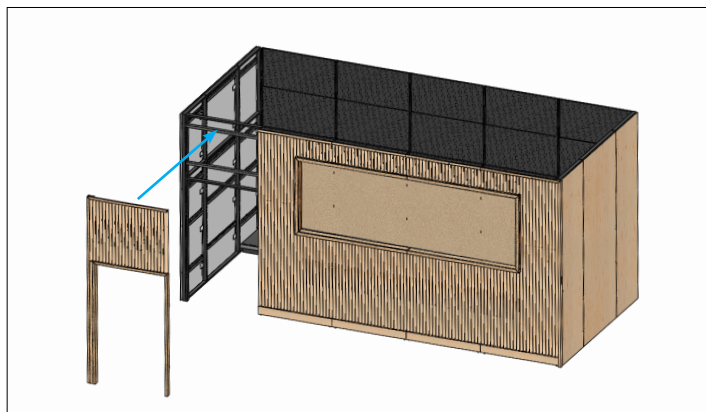

**Step 14:**  
Hang **Left Panel Assembly** over the door frame area. Ensure all z hangers are interlocked.

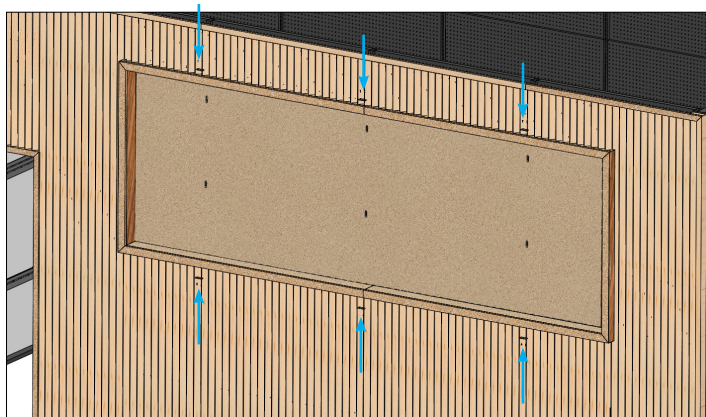

**Step 15:**  
Behind the front edge of the TV frame, add **Connection Plates** (x6) over seams to secure.

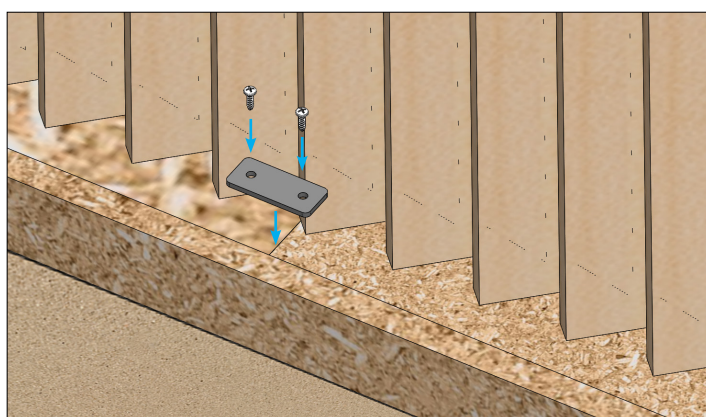

**Step 16:**  
Use **Screw, #6 x 1/2 Philips** to secure each plate.

# Back Room Flute Wall Cover

## Install Instructions

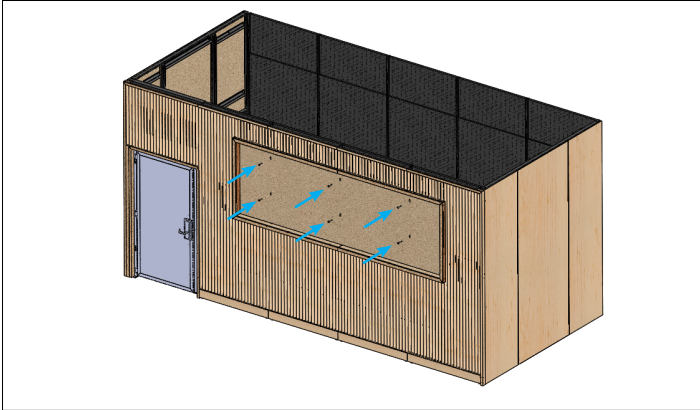

**Step 17A:**  
Use **Bolt, Hex Head 1/4-20 x 3"** with **Washer Flat 1" O.D. T0** secure **TV Frame Assembly** thru gondola uprights

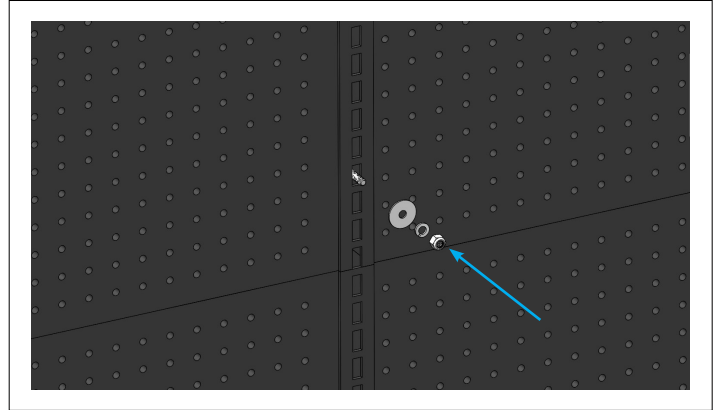

**Step 17B:**  
From the inside of the gondola system, secure each bolt with **Washer Flat 1" O.D., Lock Washer for 1/4"**, and **Lock Nut 1/4-20**.

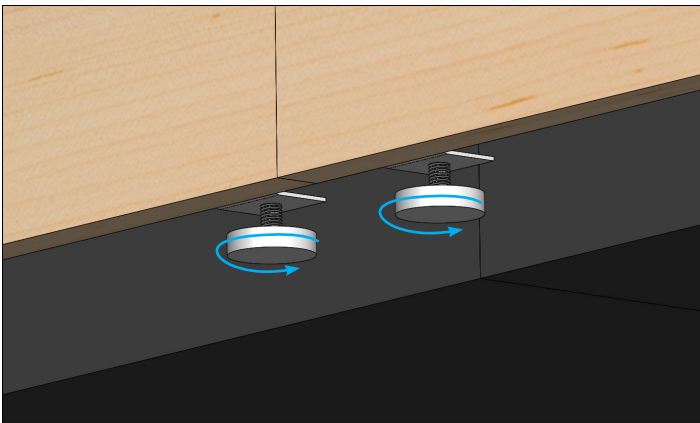

**Detail 16:**  
Lower leveling feet under front panels until they touch the ground. This will help take weight off of the gondola structure.

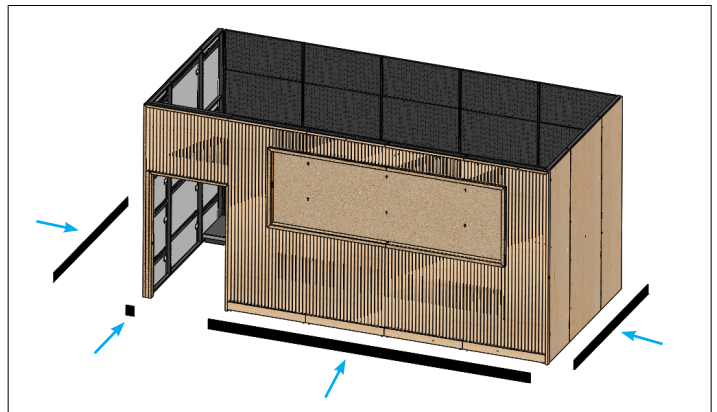

**Step 18:**  
Use construction adhesive to mount **Vinyl Base Boards**.

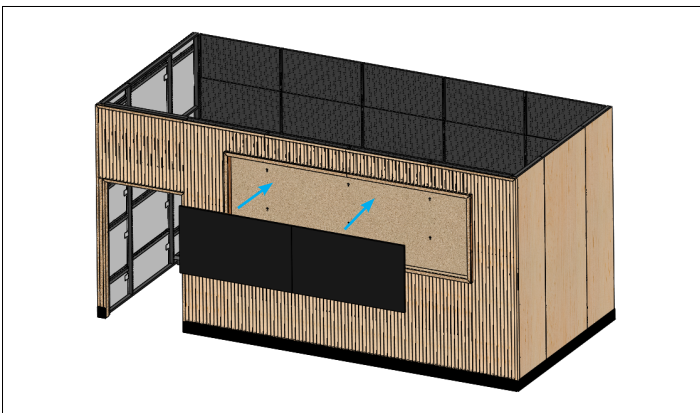

**Detail 19:**  
TVs provided by others. Mount to **Painted MDF Panel**.

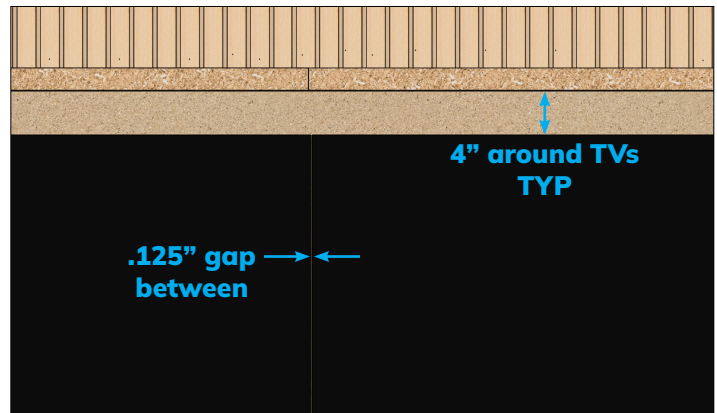

**Detail 19:**  
There should be a 4" gap around TVs to inside of **TV Frame Assembly**. Leave 1/8" gap between TVs.

Back Room Flute Wall Cover  
Install Instructions

48.56in Z Hangers

31.32in Z Hangers

Heights for Z  
Hangers Center

113.19in

71.19in

47.19in

18.19in

Heights for Z  
Hangers Left &  
Right Sides

110.12in

68.12in

44.13in

14.13in

**Back Room Flute Wall Cover**  
Install Instructions

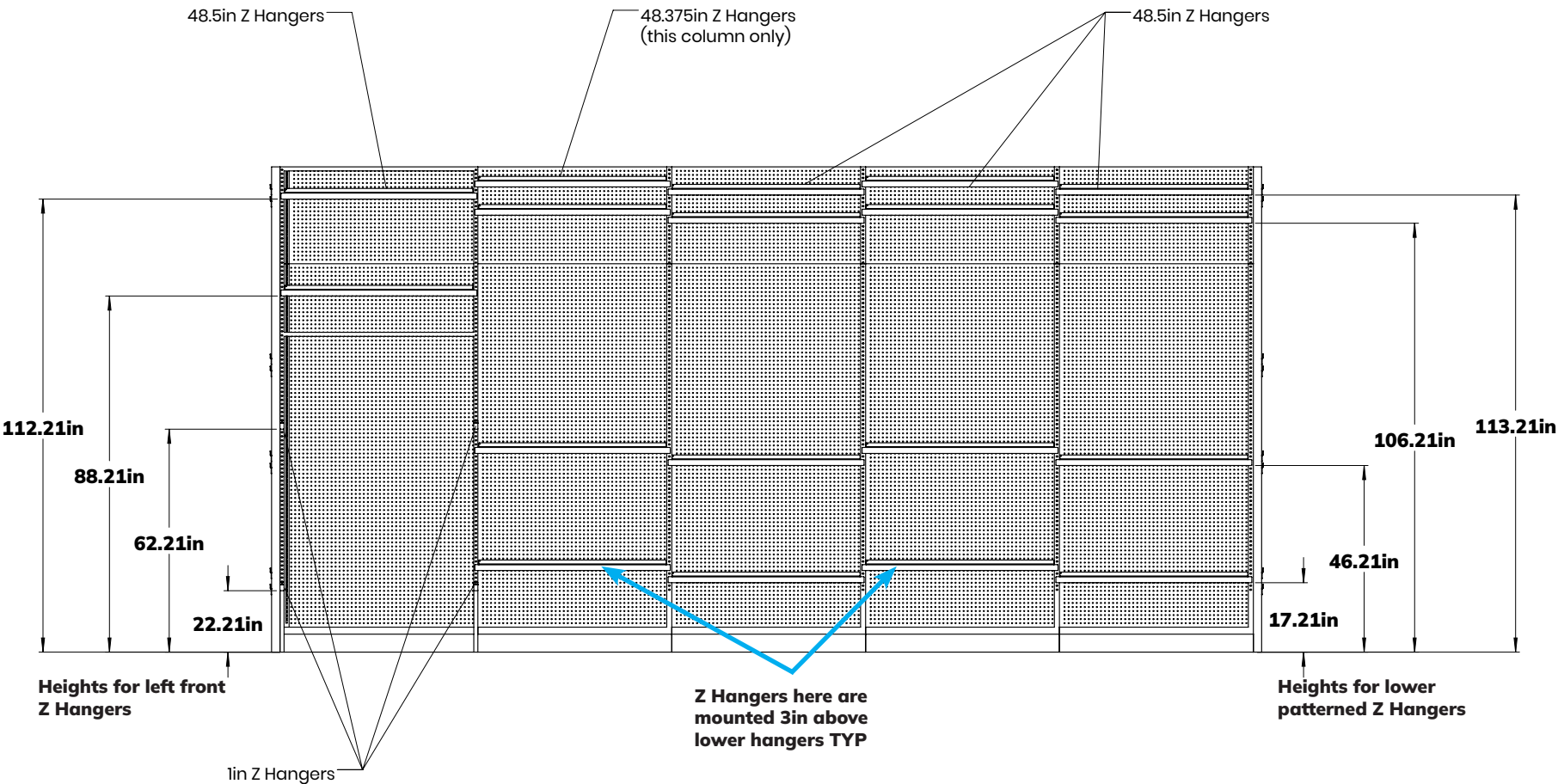

# Academy

## Sports + Outdoors

---

Nesting Tables

10/24/2024



# Project Brief

## Objective:

- Create value engineered option from existing design

## Design Requirements:

- 2-3 Options
- Same functionality & look
- “Not built like a “tank””

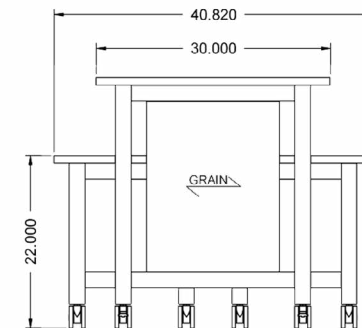
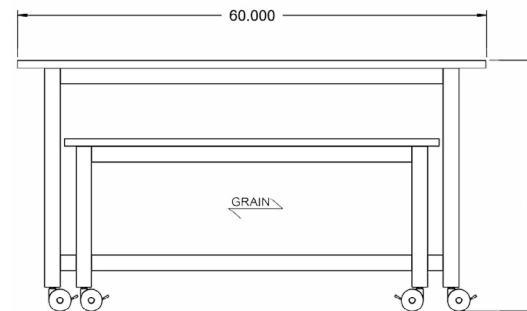
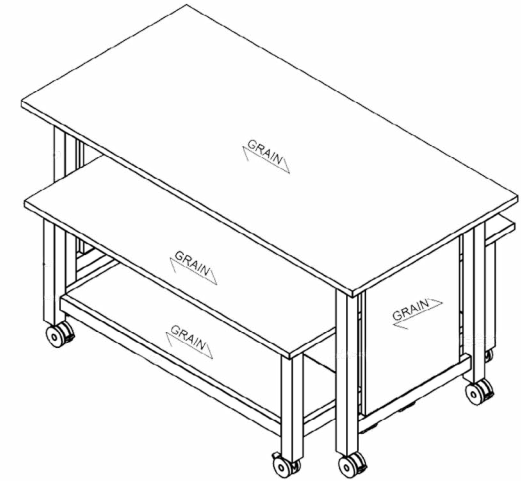
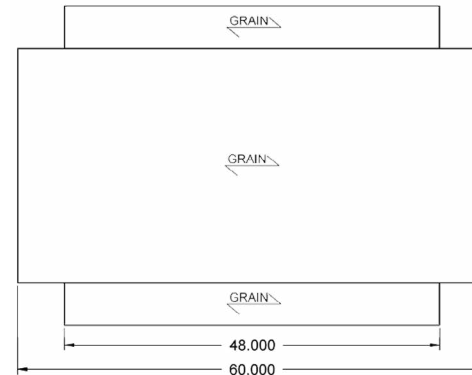

Existing Tables

# Option 1

- Reduced tube size on all around
- Maintain overall look but not as beefy



# Option 1

## Large Table



### Bill of Materials – Large Table

Item	QTY	Description	Material
1	1	BENCH TOP PANEL	HPL 1" MDF CORE
2	2	PLAIN STRETCHER A	TUBE, (16GA) .500X1.50
3	1	PLAIN STRETCHER B	TUBE, (16GA) .500X1.50
4	4	VERTICAL TUBE	TUBE, (16GA), 1.5X1.5 SQ
5	12	C-CHANNEL	STEEL A1011 CR (11Ga)
6	6	TAPPED LEVELING PLATE 3/8-16	STEEL A1101 HRPO (7Ga)
7	2	BOTTOM TUBE	TUBE, CRS (16GA) .5X1.50
8	2	TOP TUBE	TUBE, CRS (16GA) .5X1.50
9	2	SIDE PANELS	HPL 3/4" MDF Core
10	28	MACHINE SCREW 1/4-20 x .5" PHILIPS	PLAIN CARBON STEEL
11	14	SCREW #8 x 0.750 PHILIPS	PLAIN CARBON STEEL
12	2	CASTER DEPOT PSF100634BK-B	BLACK THERMOPLASTIC
13	2	CASTER DEPOT PSF100634BK	BLACK THERMOPLASTIC



# Option 1

## Small Table

### Bill of Materials – Small Table

Item	QTY	Description	Material
1	1	BENCH TOP PANEL	HPL 1" MDF CORE
2	2	PLAIN STRETCHER A	TUBE (16GA) .500X1.50 W
3	4	TOP TUBE	TUBE (16GA) .500X1.50
4	4	VERTICAL TUBE	TUBE (16GA) 1.500X1.500 SQ
5	16	C-CHANNEL	STEEL CR (11GA)
6	4	TAPPED LEVELER PLATE	STEEL HRPO (7GA)
7	32	"SCREW MS ¼-20 X 0.500 PH PH ZC MCM# 90272A537"	Plain Carbon Steel
8	6	"SCREW SMS #8 X 0.750 PH PH ZC MCM# 90190A197"	Plain Carbon Steel
9	2	CASTER DEPOT PSF100634BK-B	BLACK THERMOPLASTIC
10	2	CASTER DEPOT PSF100634BK	BLACK THERMOPLASTIC
11	2	PLAIN STRETCHER B	TUBE (16GA) .500X1.50
12	2	3/4 X 3/4 L CHANNEL SHELF SUPPORT	STEEL CR (16GA)
13	1	LOWER SHELF	HPL 3/4" MDF CORE
14	6	"SCREW SMS #8 X 0.625 PH PH ZC MCM# 90190A196"	Plain Carbon Steel

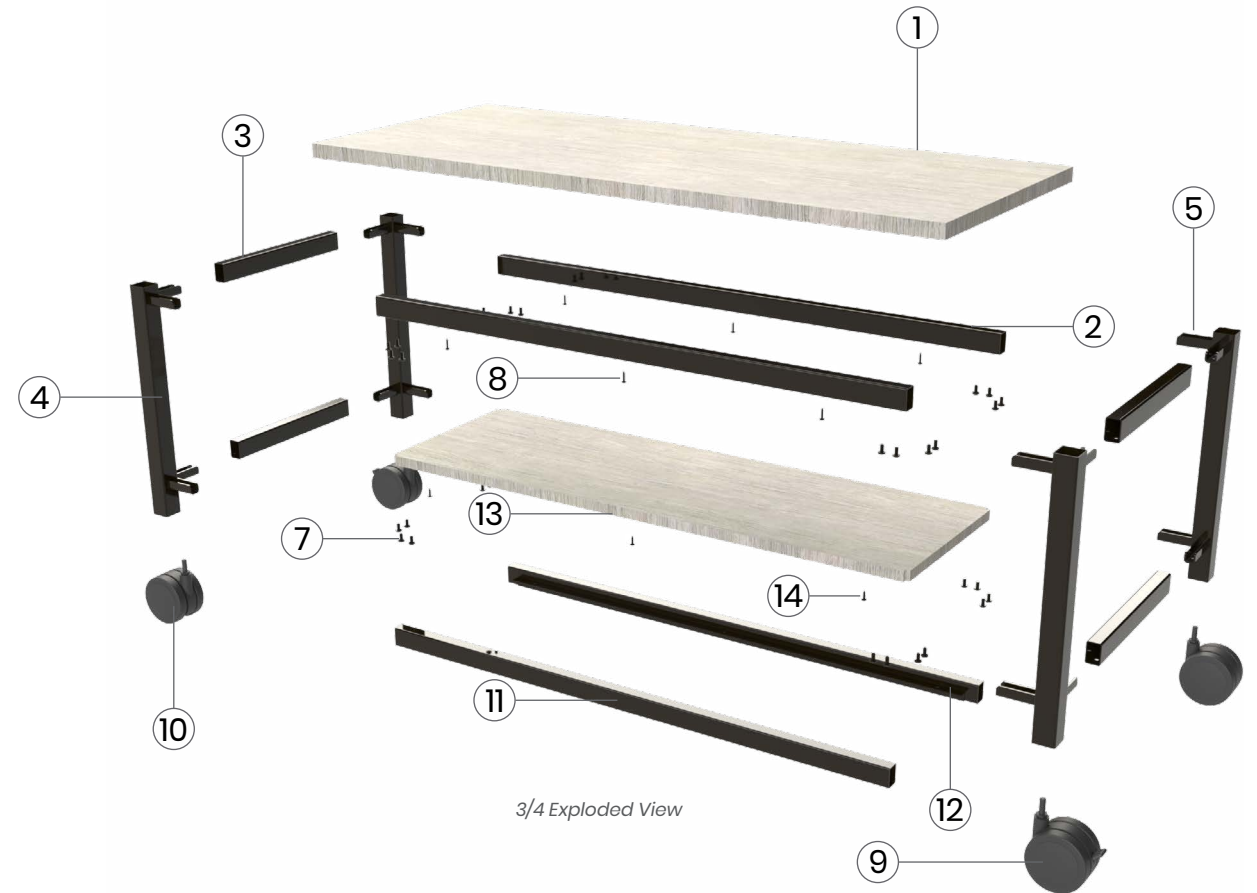

# Option 2



- All dimensions same as Option 1
- Reduced tube size on all around
- Removed side panel for slimmer design
- Small table same as in Option 1



Front View

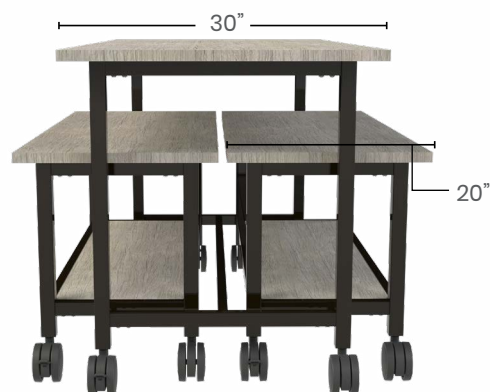

Side View



# Option 2

## Large Table



### Bill of Materials – Small Table

Item	QTY	Description	Material
1	1	BENCH TOP PANEL	HPL 1" MDF CORE
2	2	PLAIN STRETCHER A	TUBE (16GA) .5X1.5
3	1	PLAIN STRETCHER B	TUBE (16GA) .5X1.5
4	2	TOP TUBE	TUBE (16GA) .5X1.5
5	2	BOTTOM TUBE	TUBE (16GA) .5X1.5
6	14	C-CHANNEL	STEEL CR (11GA)
7	4	VERTICAL TUBE	TUBE (16GA) 1.5X1.5 SQ
8	4	TAPPED LEVELER PLATE	STEEL HRPO (7GA)
9	28	"SCREW MS ¼-20 X 0.500 PH PH ZC MCM# 90272A537"	Plain Carbon Steel
10	6	"SCREW SMS #8 X 0.750 PH PH ZC MCM# 90190A197"	Plain Carbon Steel
11	2	CASTER DEPOT PSF100634BK-B	BLACK THERMOPLASTIC
12	2	CASTER DEPOT PSF100634BK	BLACK THERMOPLASTIC



# Option 3



- Reduced tube size on all around
- Sheet steel lower shelf on small tables
- C-channels with 2mm graphic on sides



Steel Shelf

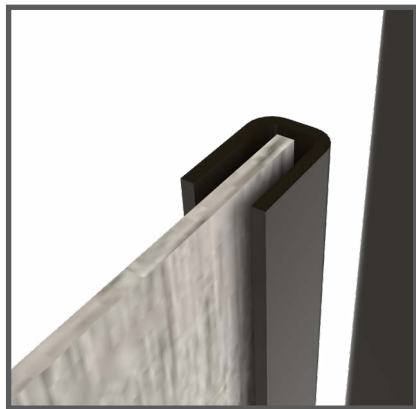

U Channel for Graphic



# Option 3

## Large Table



### Bill of Materials – Small Table

Item	QTY	Description	Material
1	1	BENCH TOP PANEL	HPL 1" MDF CORE
2	2	PLAIN STRETCHER A	TUBE (16GA) .5X1.5
3	1	PLAIN STRETCHER B	TUBE (16GA) .5X1.50
4	4	VERTICAL TUBE	TUBE (16GA) 1.5X1.5 SQ
5	14	C-CHANNEL	STEEL CR (11GA)
6	4	TAPPED LEVELER PLATE	STEEL HRPO (7GA)
7	2	BOTTOM TUBE	TUBE (16GA) .5X1.5
8	2	TOP TUBE	TUBE (16GA) .5X1.5
9	2	SIDE GRAPHIC	DIRECT PRINT ON 2MM COROPLAST
10	28	"SCREW MS ¼-20 X 0.500 PH PH ZC MCM# 90272A537"	Plain Carbon Steel
11	6	"SCREW SMS #8 X 0.750 PH PH ZC MCM# 90190A197"	Plain Carbon Steel
12	2	CASTER DEPOT PSF100634BK-B	BLACK THERMOPLASTIC
13	2	CASTER DEPOT PSF100634BK	BLACK THERMOPLASTIC

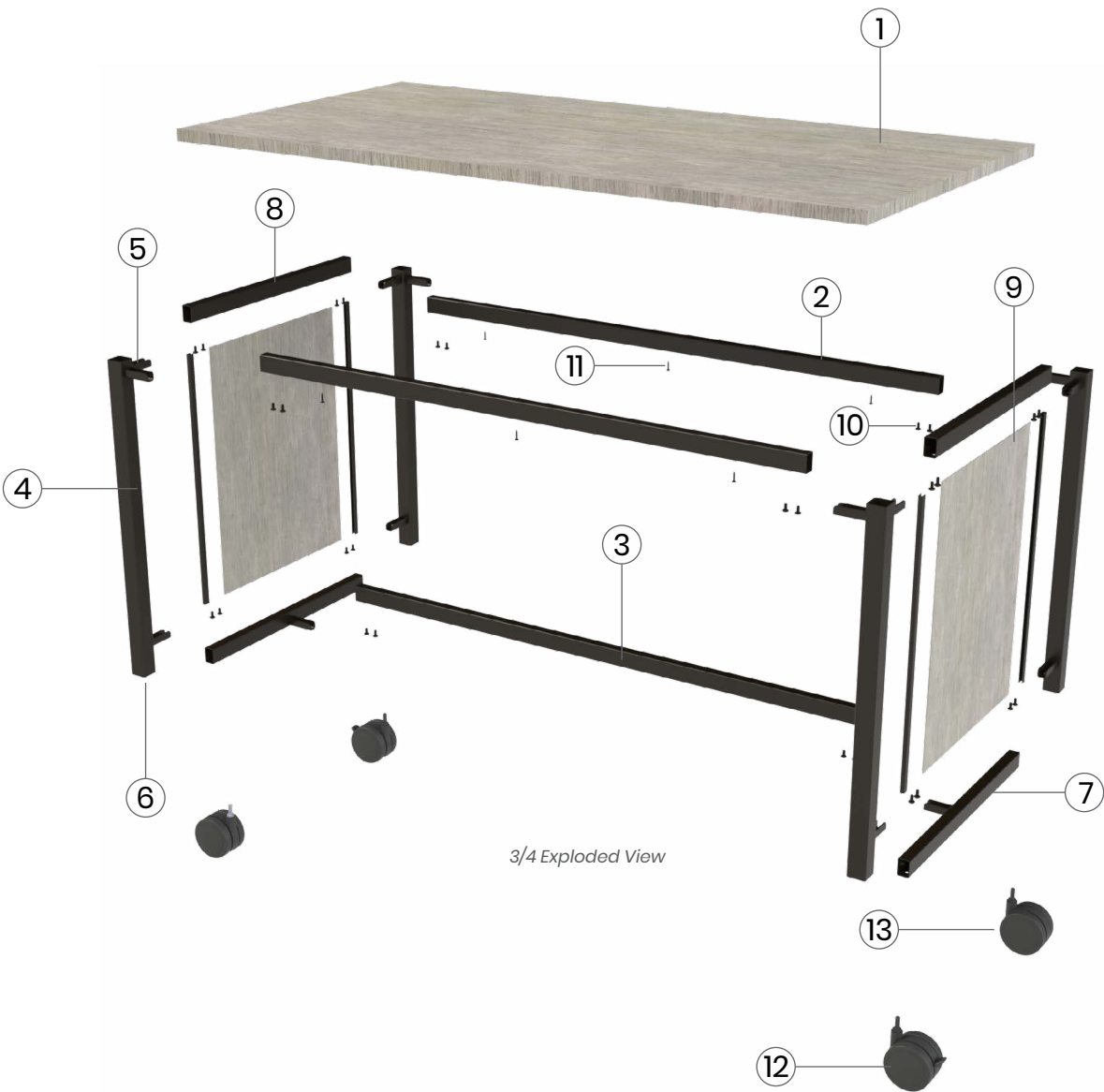

# Option 3

## Small Table

### Bill of Materials – Small Table

Item	QTY	Description	Material
1	1	BENCH TOP PANEL	HPL 1" MDF CORE
2	2	PLAIN STRETCHER A	TUBE (16GA) .5X1.5
3	4	TOP TUBE	TUBE (16GA) .5X1.5
4	4	VERTICAL TUBE	TUBE (16GA) 1.5X1.5 SQ
5	16	C-CHANNEL	STEEL CR (11GA)
6	4	TAPPED LEVELER PLATE	STEEL HRPO (7GA)
7	32	"SCREW MS ¼-20 X 0.500 PH PH ZC MCM# 90272A537"	Plain Carbon Steel
8	6	"SCREW SMS #8 X 0.750 PH PH ZC MCM# 90190A197"	Plain Carbon Steel
9	2	CASTER DEPOT PSF100634BK-B	BLACK THERMOPLASTIC
10	2	CASTER DEPOT PSF100634BK	BLACK THERMOPLASTIC
11	2	PLAIN STRETCHER B	TUBE (16GA) .5X1.5
12	1	LOWER SHELF	STEEL CR (16GA)



**THANK YOU**

# REFERENCES

Zak Rose  
Zakrose Inc. / Chicago, IL  
<https://www.zakrose.com/>  
[zak@zakrose.com](mailto:zak@zakrose.com)  
(847) 372\*7309

Andrew Kephart  
ISM Design / Chicago, IL  
<http://www.ismfurniture.com/>  
[ismfurniture@earthlink.net](mailto:ismfurniture@earthlink.net)  
(773) 504-7577

Dan Sullivan  
Navillus Woodworks / Chicago, IL  
<https://www.navilluswoodworks.com/>  
[dan@navilluswoodworks.com](mailto:dan@navilluswoodworks.com)  
(312) 375-2680



Andrew Kephart

Dan Sullivan

Zak Rose